

Electrical connection suggested side

Drain pipe

Heat exchanger outlet

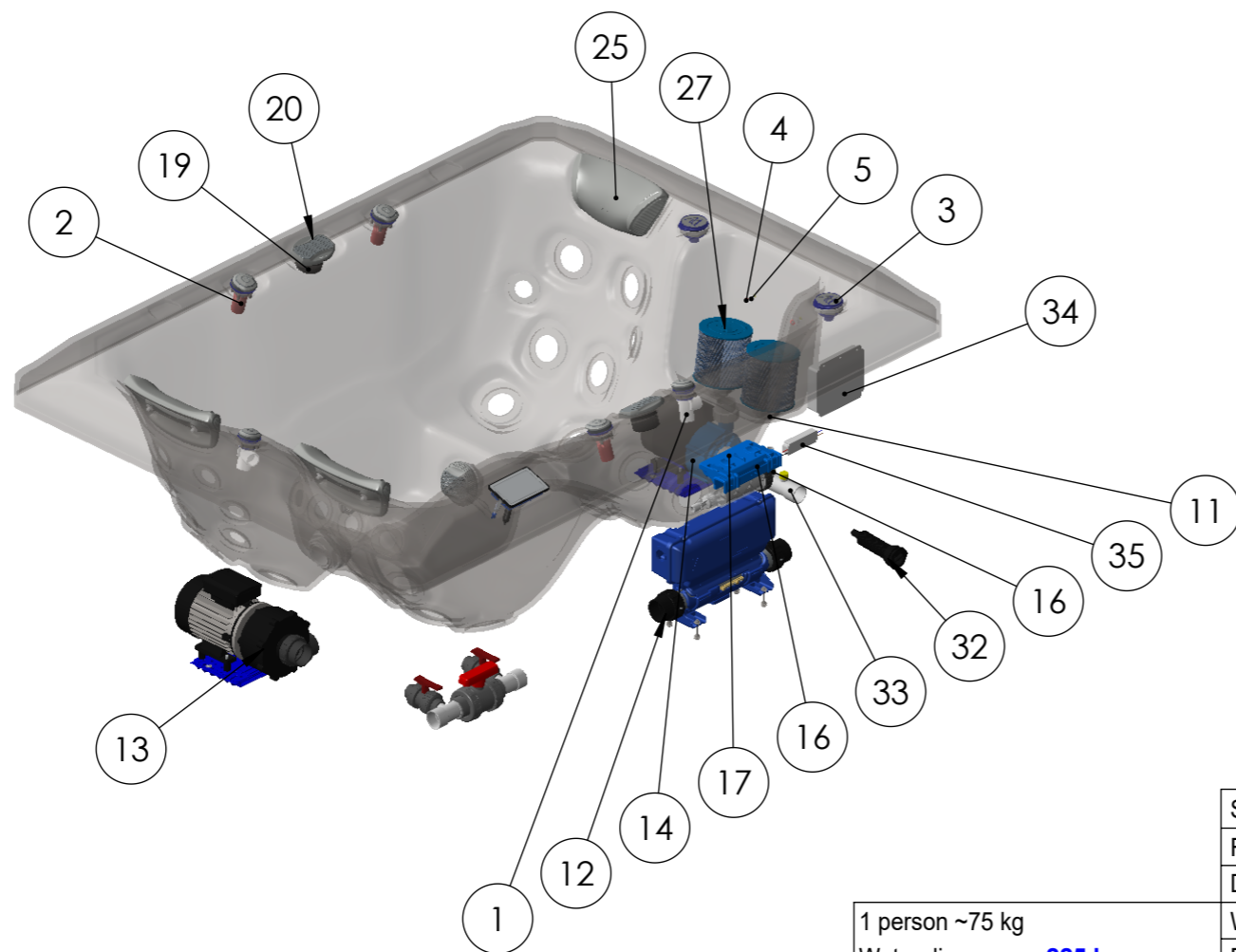
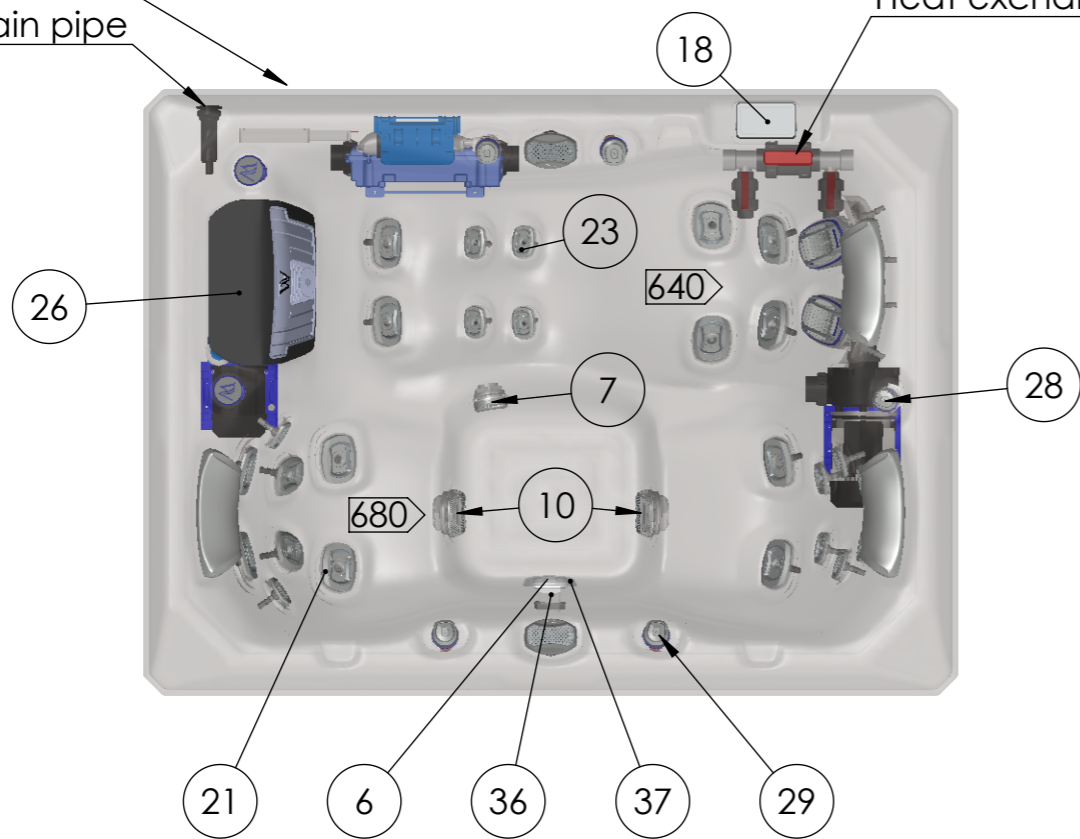

No.	Art. No.	IFS Name	Pcs
1	AKU2718	On-Off tap house 33 transparent V2	2
2	AKU2716	Air Regulator 33 transparent light grey Life	3
3	AKU2437	Cup Holder Light - lens wellis 2020	2
4	AKU2647	Led housing with seal	2
5	AKU2219	Nut for ledhouse	2
6	AJ00291	Jet ozone with sealing V2	1
7	AJ00294	Jet water circulation self-leveling light grey 48 Life	1
8	AJ00277	7" jet body oscillator 2020	2
9	AJ00278	7" jet fixation console 2020	2
10	ABE0525		2
11	AKU1840	Filter holder - 48 mm	2
12	ACM1051	Control box In.YE-3	1
13	ACM0080	Spa Pump 3 HP - One Speed	1
14	ACM0846	Circulation pump WTC50M 250 W 0.33 Hp	1
15	ABE0621	Ozon mixer - Housing	1
16	ABE0620	Mixer housing	1
17	ACM0999	Ozone - Generator P54 100 mA	1
18	ACM0912	Control Panel - IN.K1000 V2	1
19	ACM0874	Speaker 3" (2 way)	2
20	ACM0972	Speaker grill Life	2
21	AJ00273	5" jet face 2020	14
22	AJ00271	5" jet insert spinning 2020	1
23	AJ00266	3" jet face 2020	16
24	AJ00265	3" jet insert 2020	16
25	AF00066	Pillow 24x17 light gray	3
26	AKU2235	Schimmer with opening grid	1
27	AKU0136	Spa Filter - 175 × 152 - Wellis Antimicrobial blue (fine Thread)	2
28	AKU2719	On-off tap grip light gray Life Wellis	2
29	AKU2717	Air regulator grip light gray Life Wellis	3
30	AJ00272	5" jet insert swirling 2020	5
31	AJ00270	5" jet insert directional 2020	8
32	AKU0084	Water Drain - 20 RB V2	1
33	AE00874	WIS probe housing (Optional)	1
34	ACM1128	WIS main unit (Optional)	1
35	ACM1129	WIS power adapter (Optional)	1
36	AKU2697	Underwater light housing (Optional)	1
37	AKU2692	Cap for underwater light Web/City (Optional)	1

You must install a 30 mA residual-current device (RCD).

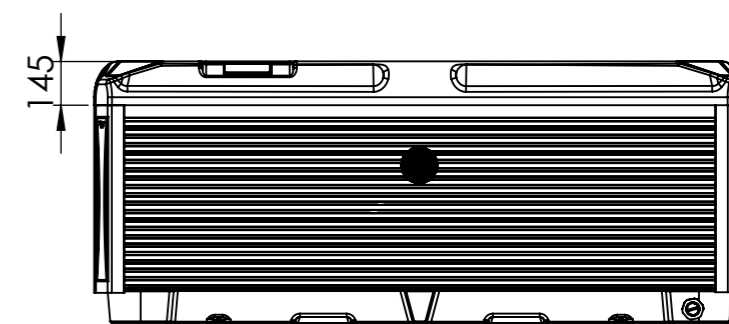

Product family: **Wellis\PeakLife**

Sheet name: Teide Life spa		Projection			
File name: FJ_WM00759_ENG_Teide_life_medicine					
Dimension SPA: 1600x2150x865 mm		Min.El. nds: 230 V - 16A - 50Hz / Opt.El. needs: 230V - 25A - 50Hz			
Weight of the SPA: 311 kg		Raklap 2370x980 - AE00897		Control box: Gecko IN.YE-3 + IN.K1000	
Rim height: 145 mm		Approved by: Loszteiner Sándor		Pr. No: Fe. No:	
Minimum water: 750 liter		Created: 2023. 04. 04.		Number: WM00759	
		Drawer: loszteiner.sandor - 2023. 04. 04. 12:21:41		A3 M 1:20 page 1 / 2	

INSTALLATION INSTRUCTIONS

Installation, connection and electrical installation can be done only by professionals!

The given dimensions are for information only, they can differ in reality than written on the drawings, due to the manufacturing technology of the pools.

ATTENTION!

Pools are installed only when electric shock protection compliance of the installed residual-current device is stated by the installation personnel in written form.

COMMISSIONING INSTRUCTIONS

1. Preparation of the area

a. Interior/Basement

In case of placing the pool inside a building take in consideration the following requirements: The base must have a proper drain channel to prevent water collecting around the pool.

If building a new place for the pool, it is strongly recommended to install a floor drain to prevent damage due to water overflow or mechanical failure, etc.

If no floor drain is installed, our Company takes no responsibility for occurring damages.

Inside the room, where the pool is installed, humidity can highly increase. To prevent precipitating water and occurrence of fungus, proper ventilation of the room is highly recommended.

It is recommended to install a dehumidifier device in the room.

b. Outdoor/Closed terrace

For proper installation of the pool, a **solid, horizontal** base is essential. Make sure that the pool is properly supported.

You must know the load capacity of the base.

Consult a specialist in architecture or a static engineer.

You can find the weight, contents and parts of the pool on the data table.

This weight should not exceed the calculated static capacity, otherwise damage can occur on the pool or base.

If the pool is installed outdoor, it is recommended to build a horizontal, reinforced concrete base with min. 10-15 cm thickness.

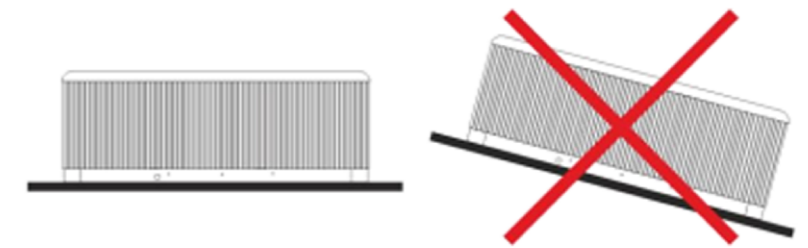

It is appropriate to make the drain channel in the base on the drain side of the pool. Its purpose is to take away splash water around the pool, or drain the released water.

It is also necessary to provide water drainage in the manhole.

The manhole should also ventilate properly. It is recommended to install an exhaust fan or other ventilation device.

Do not expose the empty pool to direct sunlight without adequate protection (pool cover). The long lasting sunlight can damage the surface of the pool or other accessories.

The acrylic surface quickly absorbs the heat from sunlight. Due to high surface temperature, the pool may be damaged.

In case the pool is installed between glass walls, prevent sunlight directly reaching the pool through the glass. Otherwise temperature can get very high.

2. Installation of the pool

When the pool is built-in (lowered into the ground), it is necessary to build a min. 60 cm wide manhole around the pool, to provide space for maintenance works.

When lowering the pool, **the acrylic side must be above the ground.** When not fulfilling these conditions, installation may fail!

The incurring cost of a possible lifting operation is borne by the customer!

3. Electrical installation

You must install a circuit breaker dedicated only for the pool, no other devices allowed to connect.

Cable length/cross-section specifications:

- Minimal demand: Until **10 m cable length: 1x16 A, 3x2.5 mm² cabling (230V)** - in this case the 3 HP motor and the heating CAN'T work simultaneously.

- Total demand: Until **10 m cable length: 1x25 A, 3x4 mm² cabling (230V)** - in this case the 3 HP motor and the heating CAN work simultaneously.

- If more than 10 m of cable is needed, consult a specialist.

- Installing the cables is recommended through the bottom cover (tray) by drilling a hole and using a cable gland. Recommended direction is shown on the drawing. Min. cable length for installation is 3 m.

- The exact way of electrical installation is always unique, highly dependant on the location and environment of the pool.

Additional electrical installation (cable, circuit breaker and residual-current device) is the customer's responsibility.

These parts are not included in the pool packaging, need to be purchased separately.

Every pool has a dedicated installation drawing.

Make sure that the pool is connected to a 30 mA residual-current device.

Use copper wiring only.

If a fuse fails, replace it only with same type of fuse with same technical parameters.

The device must be connected to the house's Equipotential Bonding Grid.

Product family: **Wellis\PeakLife**

Sheet name: INFO	Projection	
File name: FJ_WM00759_ENG_Teide_life_medence		
Dimension SPA: 1600x2150x865 mm	Min.El. nds: 230 V - 16A - 50Hz / Opt.El. needs: 230V - 25A - 50Hz	
Weight of the SPA: 311 kg	Raklap 2370x980 - AE00897	Control box: Gecko IN.YE-3 + IN.K1000
Rim height: 145 mm	Approved by: Losteiner Sándor	Pr. No: Fe. No:
Number: WM00759	B	
Created: 2023. 04. 04.	Drawer: losteiner.sandor - 2023. 04. 04. 12:21:41	A3 M 1:15
		page 2 / 2

1 person ~75 kg	
Water disp.: 225 kg	
Minimum water: 750 liter	