



SECURitech first



SECURitech design



SECURitech



SECURitech design solar



SECURitech solar

**NOTICE DE MONTAGE** - INSTALLATION MANUAL  
MONTAGEHANDLEIDING - MONTAGEANLEITUNG  
ISTRUZIONI DI MONTAGGIO - ADVERTENCIA DE MONTAJE

GAMME - RANGE - GAMMA - PRODUKTREIHE - GAMMA - GAMA

**SECURitech**

Volets de sécurité hors d'eau / Above water slatted safety cover /  
Veiligheidsrolluiken boven de waterlijn / Sicherheitsabdeckung über  
der Wasseroberfläche / Coperture avvolgibili di sicurezza fuori acqua /  
Persianas de seguridad fuera del agua

The **SECURitech** range of above water Slatted Safety Covers  
Designed and manufactured in Compliance with French NF P90-308 standards

- Recommendation for installation

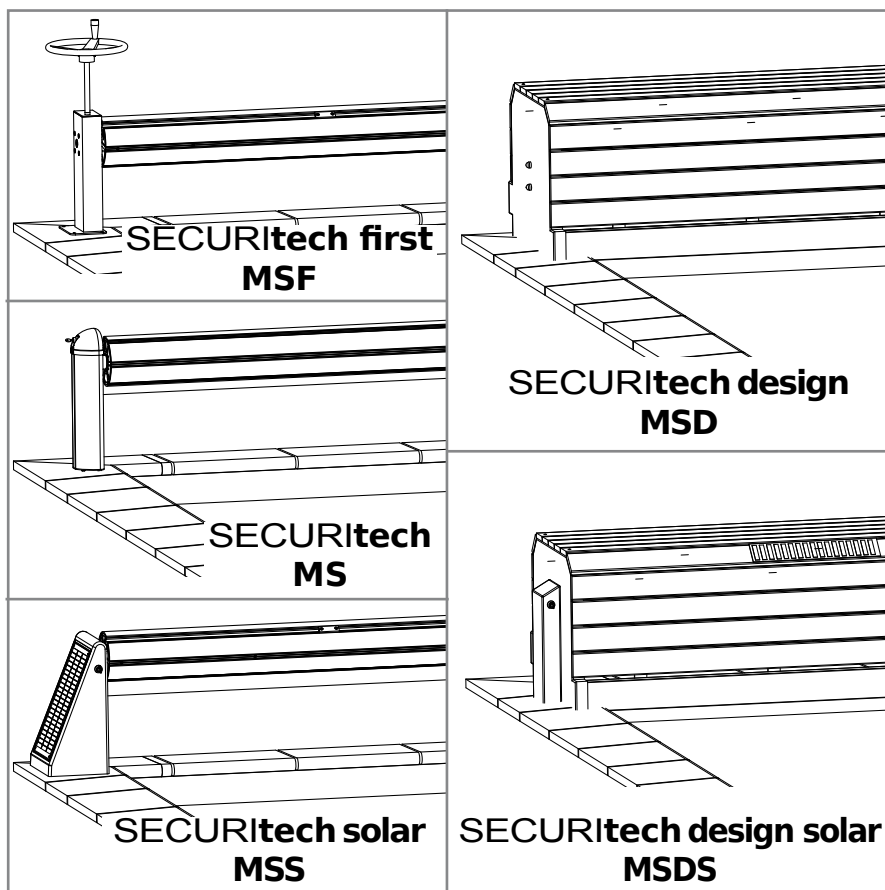

Models:

MSF - MS - MSS - MSD - MSDS

Note the model and the number  
shown on the container  
for the after sales service  
of your equipment.

Number:

Address and phonenumber dealer/installer

# The **SECURitech** range of above water Slatted Safety Covers

Designed and manufactured in Compliance with French NF P90-308 standards

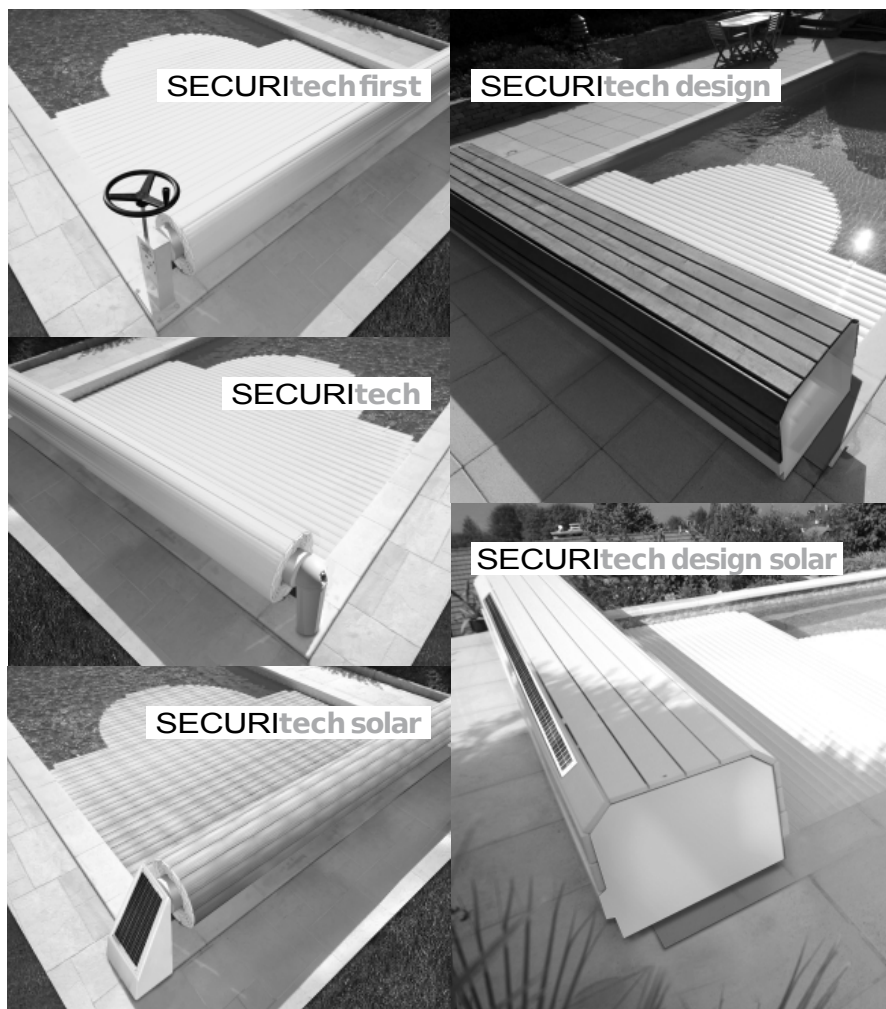

**1** **Delivery**  
*Slatted safety cover components*  
*Equipment necessary for assembly*

**2** **Technical instructions**  
*Shell*  
*Electricity*  
*The roller*

**3** **Installation**  
*Assembly*  
*Electrical connection and adjustment of the motor travel stops*

**4** **Finishes**  
*The slatted cover apron*  
*The safety mechanisms*  
*Installation of the safety components*



Our safety cover is designed in order to prevent access to the swimming pool of children under 5 years of age when it is closed and locked.

**The floating slatted safety cover is not a substitute for your good sense or for your responsibilities. It does not replace the vigilance of a responsible adult, which remains the essential factor for the protection of young children.**



This instruction manual is intended for the person in charge of installing and putting a floating slatted cover into service, it should then be handed over to the owner of the swimming pool so that she or he can take full advantage of the slatted cover. This will permit the avoidance of some common mistakes for the user's complete satisfaction with her or his slatted cover, which is among the most effective available.



These directions are mandatory: the application of the maker's warranty depends on their observance. The installer alone is liable for any consequence of non-observance of the maker's directions : Atriblue.

**Edition: 01/2009**



Read all of the instructions before installation.  
- Use solely the materials supplied by the manufacturer.



To ensure the protection of the slatted cover, it is delivered in a non-reusable wooden container measuring at least 40 cm more than the width of the pool. The whole is heavy and fragile and the presence of several persons (2 to 6) or of handling equipment is necessary for its unloading.

#### Mass in kg of a slatted cover packed in a container

Pool dimensions (m)	SECURltech first	SECURltech SECURltech solar	SECURltech design SECURltech design solar		Container size (m)
				WOOD	
<b>4 x 8</b>	290	295	335	410	4,5 x 0,6 x 0,8(h)
<b>5 x 10</b>	390	395	450	560	5,5 x 0,6 x 0,8(h)

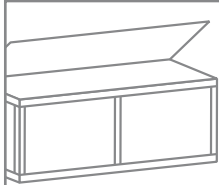

#### Slatted cover components present in the crate:

- A slatted cover apron
- A roller shaft
- Two posts (**SECURltech first**, **SECURltech**, **SECURltech solar**) or two flanges interdependent with a framework (**SECURltech design** et **SECURltech design solar**) supporting the roller shaft
- A 19x25 cm box (excluding **SECURltech first**)
- A fixing kit
- An instruction manual

We cannot be held responsible for loss or damage caused by transport. The goods travel at the addressee's own risk.

On delivery of your order, open the package in the presence of the deliveryman, to verify the condition of the goods and their conformity with the order.

Keep the original packaging.



#### Number of Persons necessary



#### Necessary time

2 to 4h min.

#### In case of damage or missing parts:

- 1) set out your reserves on the transport slip (e.g.: packaging ripped open). The sole note "subject to unpacking" is null and void.
- 2) Send the carrier a registered letter posted within 2 days following delivery. This letter should precisely set out the damage ascertained. Send a copy to the manufacturer for information.

Before installation, store the parts of the slatted cover in the container, which must not be left in the sun but stored in a place of moderate temperature.

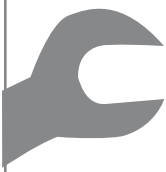

#### Necessary equipment:

- Perforateur
- Drill
- Sets of open end spanners, box spanners, Allen keys
- Set of screwdrivers
- Mallet
- Universal pliers
- Spirit level
- Hot glue gun
- Stanley knife
- Multimeter
- 10-metre tape measure

- Allow an effective overflow made up of a return fitting connected in tubing of a minimum diameter of 50 mm so as to obtain **a water level at – 12 cm below the levelling course**. We advise against overflows located inside skimmers.

-Do not fix the skimmers along the length of the swimming pool but along the pool's width.

-Strengthen the levelling course at the level of the fixings in order to avoid any risk of pulling out, with concrete **measured at 350 kg/m<sup>3</sup>** for 20 cm in height and width. You can plan the fixing of the fastening parts for flange and beam case in advance, to firmly fix all of the planned attachments.

-If the slatted cover apron is made up of translucent solar slats, it is absolutely necessary to use a backflow in the 1st riser of the staircase and in the areas of very shallow water.

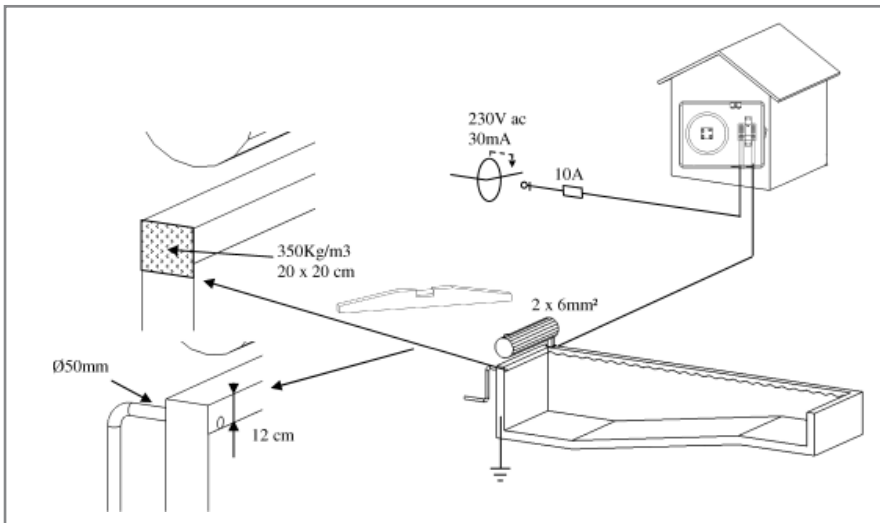

Electrical wiring necessary from the cover's electrical box to the roller mechanism

Cover model	Distance from the technical room to the swimming pool	Motor power	Motor travel stop sensors	Switch
<b>SECURltech / SECURltech design</b>	< 15 m	2 x 4 mm <sup>2</sup>	Already connected	Already connected
<b>SECURltech / SECURltech design</b>	< 30 m	2 x 6 mm <sup>2</sup>	Already connected	Already connected

**IF ADDITIONAL OPTIONAL ELECTRICAL BOX FOR COMMUNICATION WITH THE AUTOMATIC WATER TREATMENT : ADDITIONAL ELECTRIC WIRING NECESSARY**

Communication box to slatted cover box	+ and -	2 x 1,5 mm <sup>2</sup>
Communication box to automatic water treatment box	E and S1 or S2	2 x 1,5 mm <sup>2</sup>
Communication box to key operated switch contact	F and 0	2 x 1,5 mm <sup>2</sup>

## 2 Electricity

**The electrical installation must be carried out in compliance with French C15-100 standards.**

- Earth the pool and any equipment in order to drain off any stray currents, which increase phenomena of oxidation of the metals used (inox 316, aluminium 6060 anodised or Beckryzinc primed).

-The multiplicity of water treatment solutions leads us to decline our responsibility and our guarantee in case of non-respect of the balance of the water. In case of use of apparatus producing an electro-physical or electrochemical reaction, which accelerates metal corrosion, be careful to take all steps to limit its harmful effects. In general, it should be borne in mind that the need for production of an oxidising agent is reduced by 75 to 90% between an open cover and a closed cover. An electrical box is adaptable in order to make possible the signalling of the cover's position to the water treatment apparatus.

- The electrical box, installed in volume 2 and in a dry place, must be protected by a 10A circuit breaker and a 30mA differential.

-All of the cables will be freely put into in the protective sheathes and connected in watertight junction boxes, accessible and above volume 0 of the swimming pool, in order to remove any risk of oxidation and short-circuit.

-The 24Vcc and 230V or 380V electric cables should not be put into the same sheath.

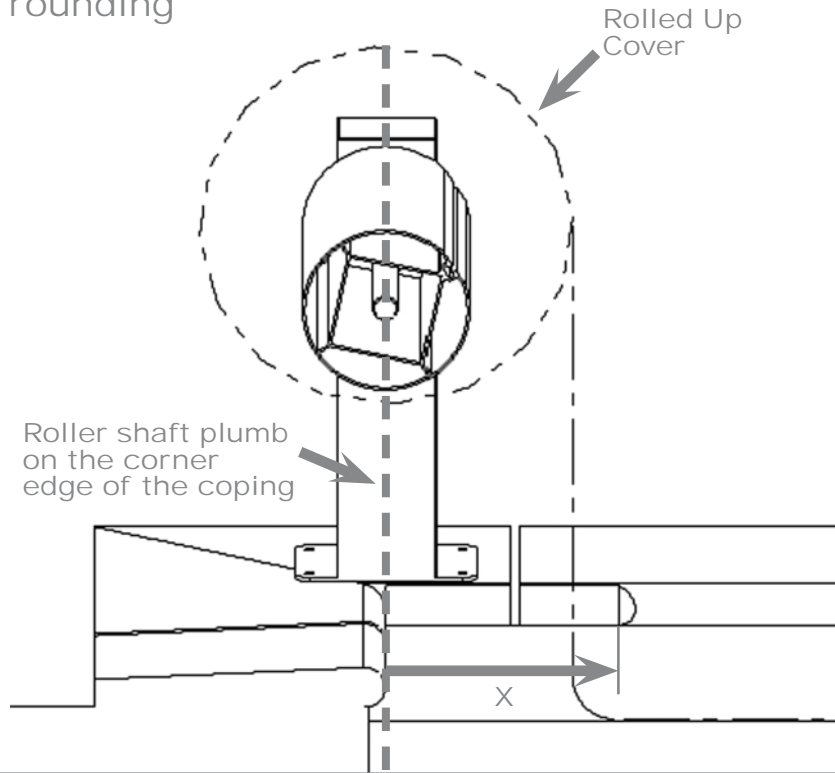
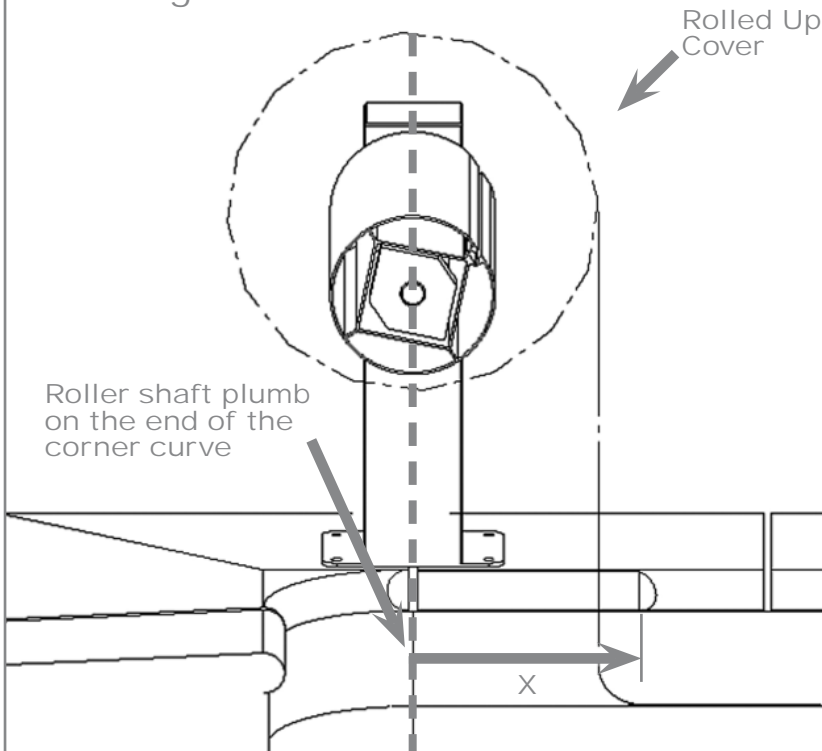
Without  
roundingWith  
rounding

## 3 The roller

- It should be set up horizontally, level and perpendicular to the length of the swimming pool.

-The **SECURItch first** cover should be operated using its hand-wheel turned with both hands

-The mechanism is declutchable on the **SECURItch**, **SECURItch solar**, **SECURItch design** et **SECURItch design solar** models and allows manual securing of the pool at any time by complete unrolling of the cover after having cut the power supply and released the motor cable.

In this case, the travel stops will need adjustment after putting the cover back into normal service.

-The two base stands of the **SECURItch range** should be fixed horizontally, level and with their bases tightened against the tube (failing which, plan in advance to attach a set collar, ordered from us, to prevent lateral play). Failure to respect these instructions may result in damage to the motor, which will not be covered by the guarantee.

- The shaft is positioned plumb above the back corner of the coping edge, or at the end of the curve if the corners are rounded, and the roller is centred along the width of the pool.

-The adjustment of the travel stops should never be carried out using a motorised apparatus

-We advise you not to fasten the attachments to the ground before having completely rolled up the slats in order to check the positioning and the adjustments.

-The threaded rods for fastening to the ground allow the insertion of nuts for adjusting the verticality of each post.

-Use silicone grease for the assembly of these parts.

-The **SECURItch design** flanges should be level and installed directly on the levelling course. The low beam is located on the side of the bathing pool.

-The slatted cover apron should rest entirely on the surface of the water, covering it completely; there may be too many slats, if so the extraneous slats should not be installed.

- It is necessary to cut the corners of the coping edges, where the slats pass, so that the slats do not rub against them when unrolling/rolling up the cover, in order to remove the risk of breaking the end caps.

- Do not operate the cover for more than 15 consecutive minutes.

Length of the slatted cover apron in m	4	5	6	7	8	9	10	11	12	13	14	15
Cut -away from the coping edge X in mm	290	300	310	320	330	340	350	360	370	380	390	400

# SECURitech first Above water slatted safety cover

- |                               |                                     |  |
|-------------------------------|-------------------------------------|--|
| <b>1</b> 1 Roller Shaft       | <b>8</b> 1 Nut M5                   | <b>15</b> 8 Nut M10                        |
| <b>2</b> 1 Drive base stand   | <b>9</b> 1 Drive shaft              | <b>16</b> 8 Washer M10                     |
| <b>3</b> 1 Bearing base stand | <b>10</b> 1 Translation stop washer | <b>17</b> 8 Thin nut M10                   |
| <b>4</b> 1 Drive cover        | <b>11</b> 2 Screw TFHC M5x12        | <b>18</b> 8 Threaded rod M10x120 + sealant |
| <b>5</b> 1 Bearing cover      | <b>12</b> 1 Screw TFHC M6x35        | <b>19</b> 1 Instructions                   |
| <b>6</b> 1 Drive hand-wheel   | <b>13</b> 1 Pin clip                |  |
| <b>7</b> 1 Screw TCF M8x70    | <b>14</b> 8 Nut covers M10          |  |

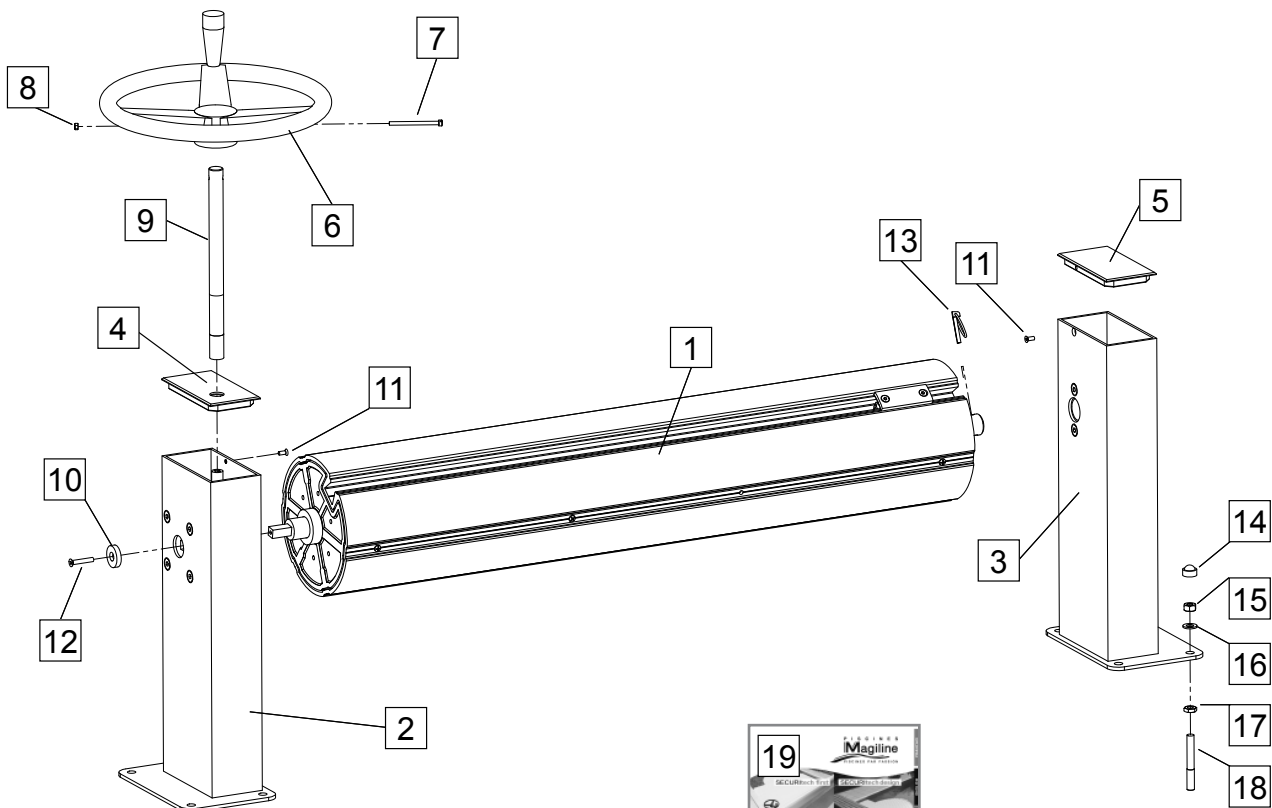

## 1 Assembly

3

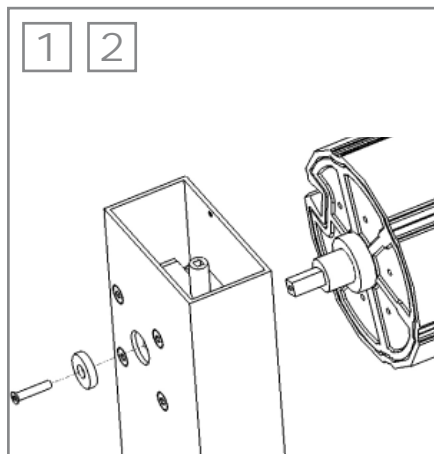

1 Insert the roller shaft's drive shaft into the base stand equipped with the reduction-unit

2 Put in place the stop washer

3 Insert the roller shaft's bearing shaft into the bearing base stand and put in place the circular pin clip

4 Fasten the two base stands against the roller shaft and position the roller beside the pool so that the shaft is level and perpendicular to the direction of unrolling of the shutter.

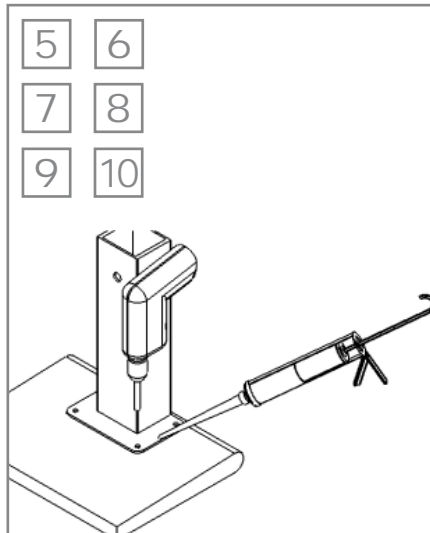
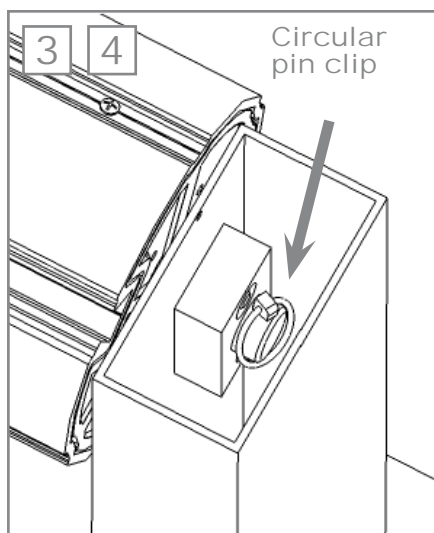

5 Mark the position of the 8 base stand fastening points

6 Shift the roller out of the way

7 Drill the coping edges at 10.5 mm

8 Fill the holes with chemical sealant following the instructions on the cartridge

9 Seal the threaded rods leaving 15 mm of rod above the base stand plate

10 Leave the sealant to dry for the time indicated on the cartridge (depending on the surrounding temperature)

11 Put the washers in place

12 Tighten the nuts and put the nut covers in place.

13 Four additional thin nuts per base stand are supplied in order to allow horizontal wedging underneath the plates. See diagram opposite

14 Fix the covers using the screws

15 Place the hand-wheel on the reduction unit

**Info: always operate the hand-wheel with 2 hands**

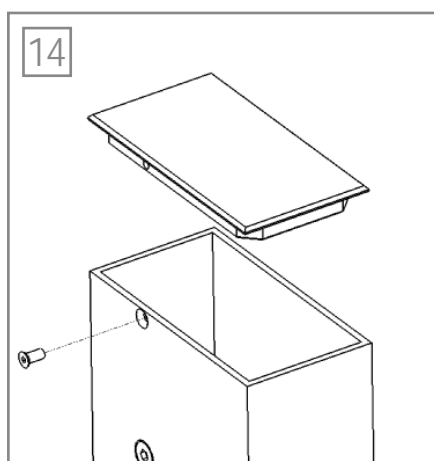
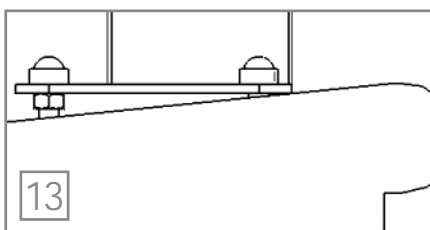
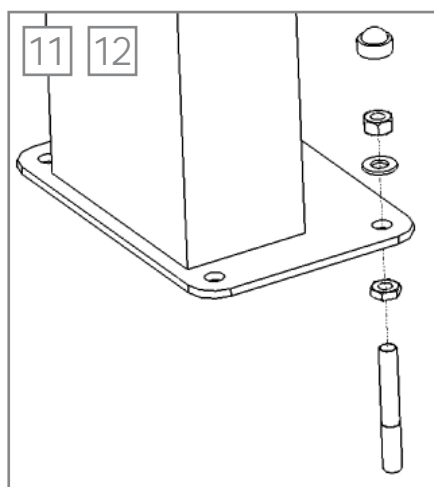



# SECURitech Above water slatted safety cover

- |  |   |
|--|---|
| <b>1</b> 1 SECURitech roller shaft       | <b>8</b> 1 Pin clip ø6  |
| <b>2</b> 1 SECURitech motor base stand   | <b>9</b> 1 Nut H M8   |
| <b>3</b> 1 SECURitech bearing base stand | <b>10</b> 1 Transformer box   |
| <b>4</b> 2 SECURitech base stand cover   | <b>11</b> 1 Above water instruction book  |
| <b>5</b> 1 Screw M8x80                   | <b>12</b> 8 Threaded rods M8x520+nut+flat washers and tooth lock washers +sealant |
| <b>6</b> 2 Washer M8                     |   |
| <b>7</b> 1 Tooth lock washer M8          |   |

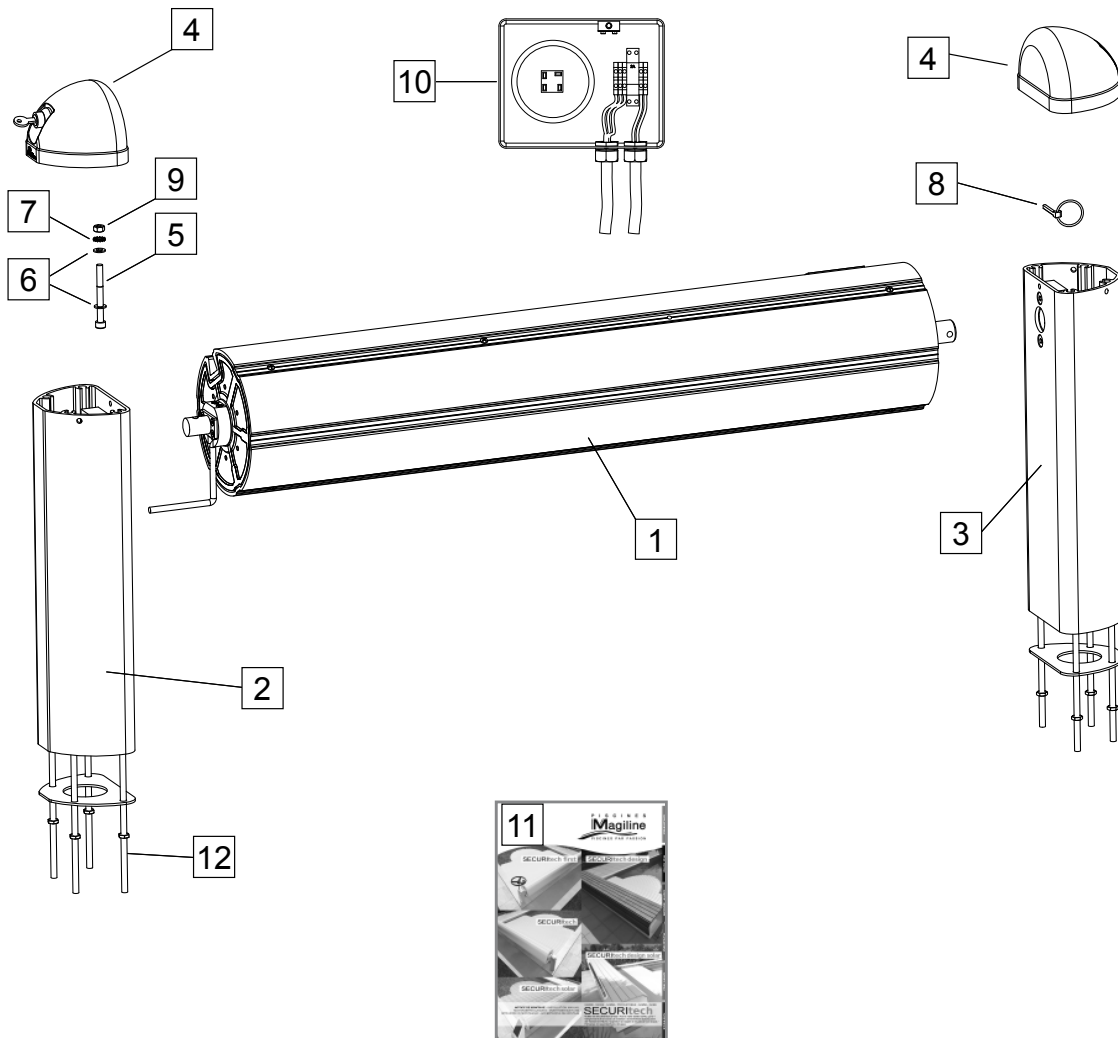

## 1 Assembly

3

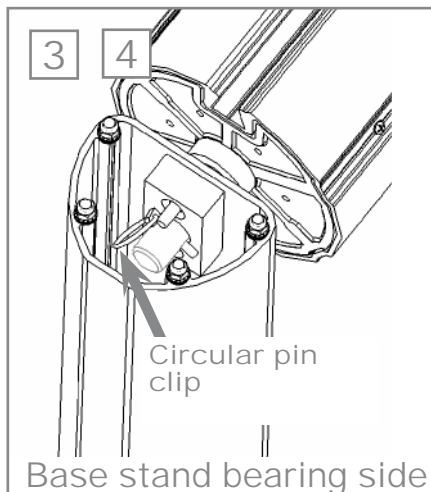
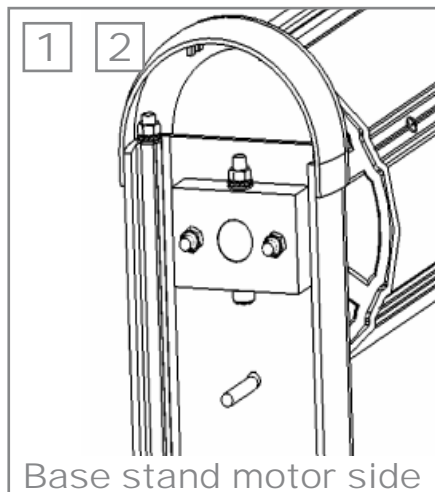

1 Insert the motor drive shaft into the base equipped with the roller shaft bearing.

2 Clip the motor drive shaft and the roller shaft bearing using the M8 nut and fasten the whole by tightening the nut over the washer above the roller shaft bearing.

3 Insert the drive shaft bearing into the other base equipped with the roller shaft bearing..

4 Put in place the circular pin clip.

5 Tighten the two base stands against the roller shaft and measure the distance between the two base stands occupied by the roller shaft in order to be able to position the roller, level and perpendicular to the direction of unrolling of the slats.

6 Transfer this measurement and mark the position of the 8 base stand fixing points using the 2 template plates.

7 Drill the coping edges at 8.5 mm. Fill the holes with chemical sealant following the cartridge instructions

8 Seal the threaded rods leaving 417 mm of rod above the template plate.

9 Laisser sécher le scellement selon le temLeave the sealant to dry for the time indicated on the cartridge (depending on the surrounding temperature).

10 Four additional thin screws per base stand are supplied in order to allow horizontal wedging under the plates.

11 Thread the template plate then the posts with the roller shaft onto the 4 threaded rods.

12 PPass the motor cable through the drilled front of the post provided on the motor side.

13 Tighten the nuts over the tooth lock washers and flat washers so as to stabilise the whole of the roller.

14 Connect the electrical wiring according to the diagram on page n°18.

15 Place the covers to close the top of the posts.

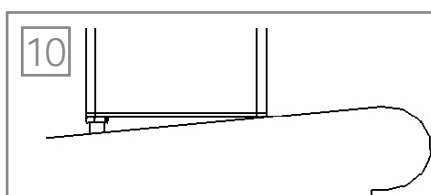
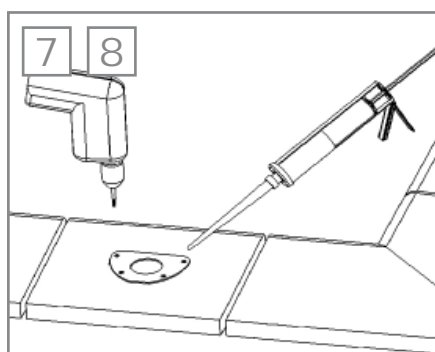
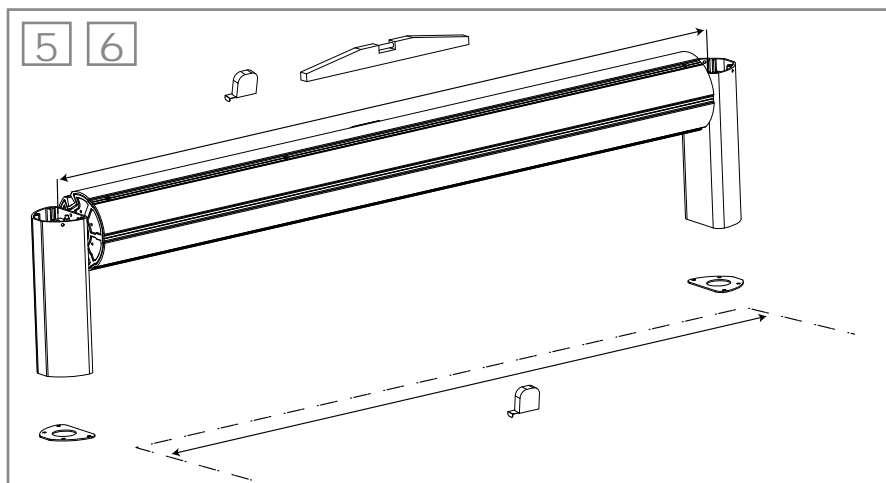

# SECURitech Above water slatted safety cover

## Optional plate fastening

- 1 2 SECURitech base stand
- 2 2 Plate
- 3 8 Screw FHC M8x60
- 4 8 Brass peg M8

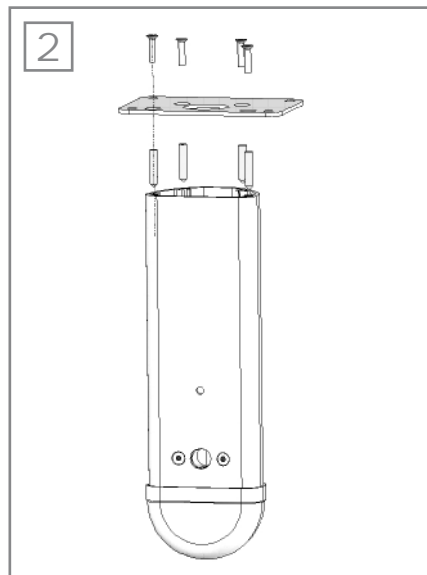
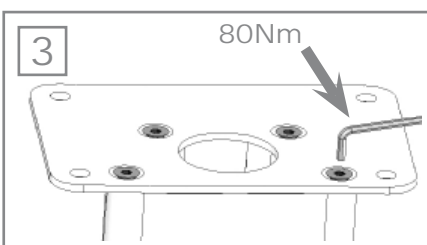
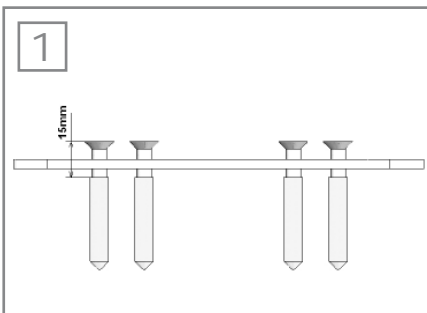
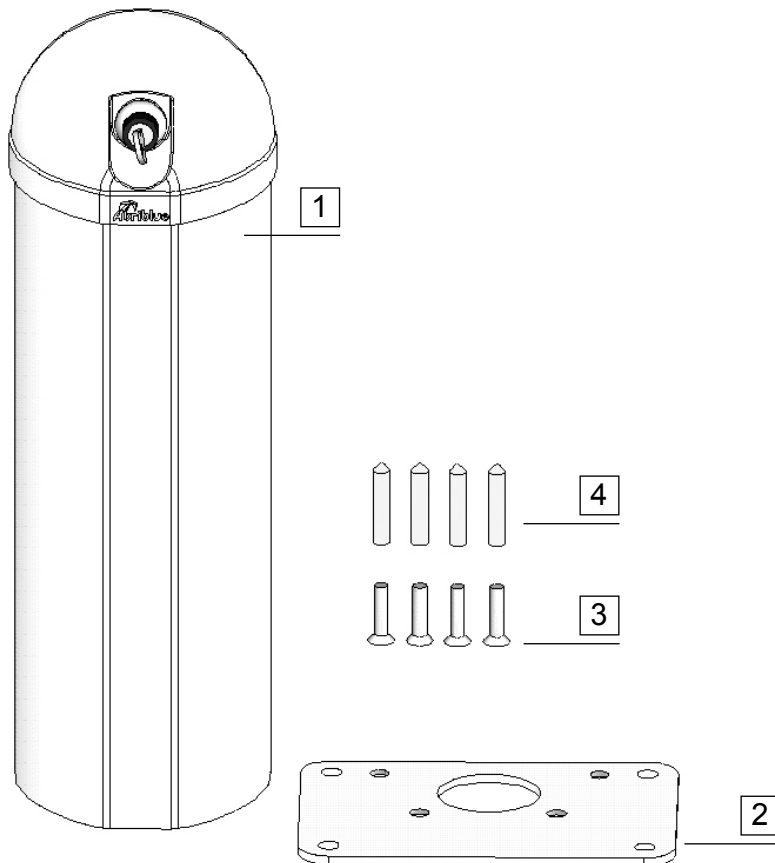

1 Fasten the screws onto the plate in the pegs so as to open the pegs a little (around 15mm).

2 Put the plate under the base stand and thread the brass pegs into the holes.

3 Fasten the screws at 80Nm with an Allen key.

4 Refer to the **SECURitech** assembly sheet for the roller assembly.

# SECURitech design Above water slatted safety cover

- |  |                                |   |
|--|--------------------------------|---|
| <b>1</b> 1 SECURitech design mechanism | <b>5</b> 2 Cable ties          | <b>10</b> 1 End stop adjustment screwdriver |
| <b>2</b> 1 Junction box                | <b>6</b> 4 Nut H M10           | <b>11</b> 1 Box                             |
| <b>3</b> 1 Removable top               | <b>7</b> 4 Flat washer M10     | <b>12</b> 1 Instructions                    |
| <b>4</b> 4 Screw TFPZ M6x30            | <b>8</b> 4 Express stud M10    |   |
|  | <b>9</b> 1 Key operated switch |   |

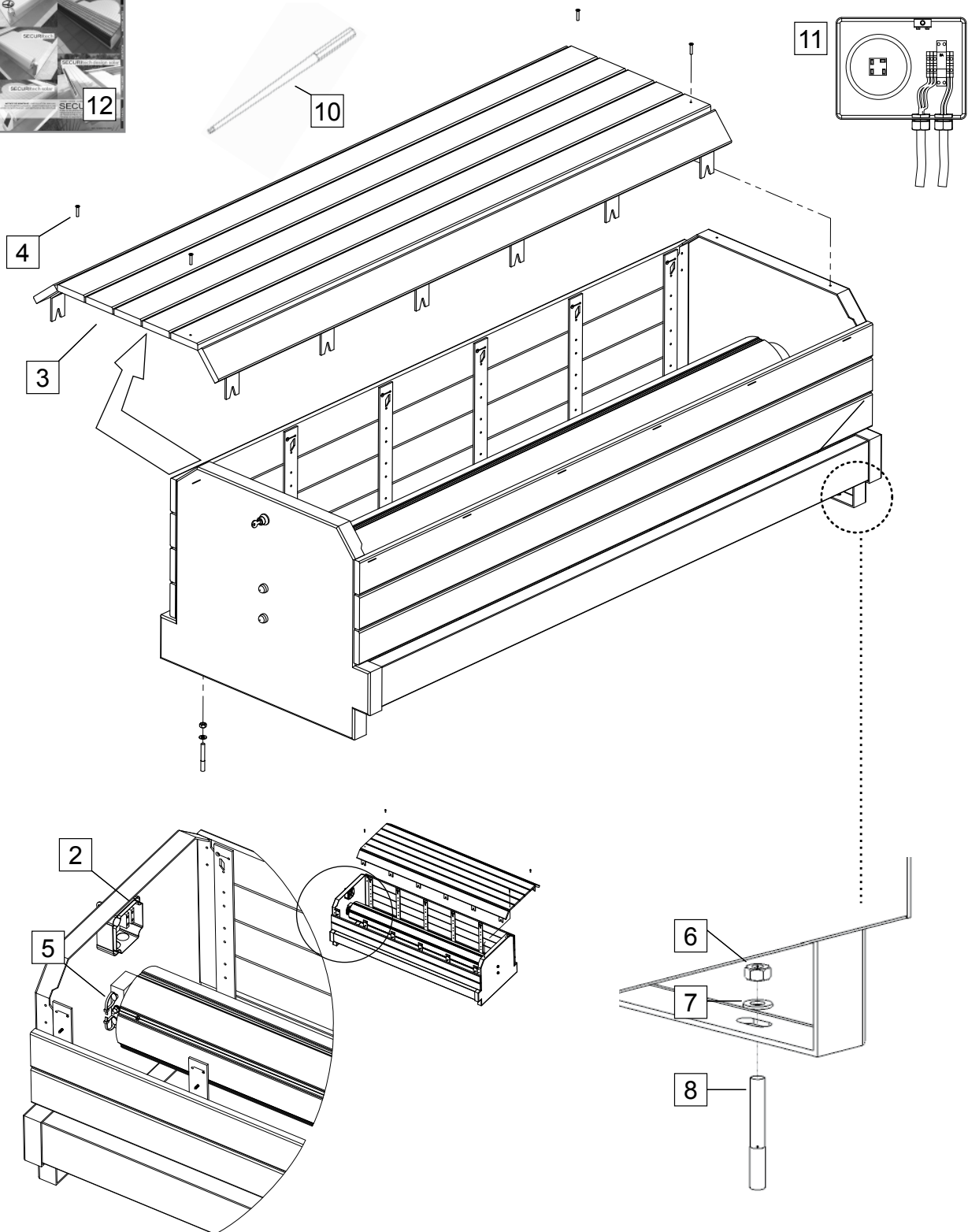



1

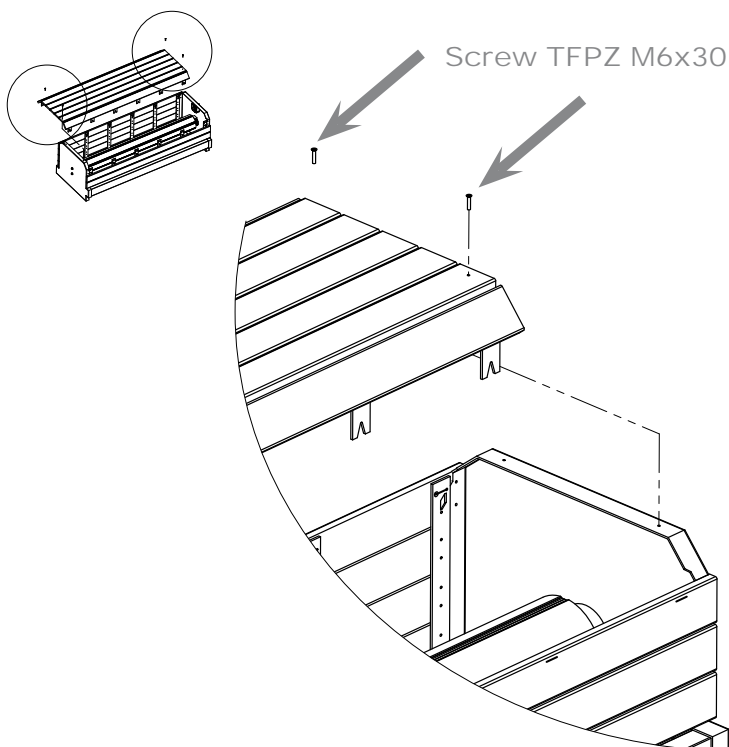

1

## Assembly

3

1 Take off the removable top by undoing the screws (TFPZ M6x30) and lifting up the whole of the panel (2 people necessary) to gain direct access to the motorised shaft. For widths greater than 6m the top is in two parts to be removed separately.

2 Position the bench directly on the levelling course (low beam facing the bathing pool) so that the roller shaft is level and perpendicular to the direction of unrolling of the slatted cover.

3 Open the cover of the junction box inside the bench.

4 Thread the power cable and the motor cable into the cable ties then tighten them.

5 Connect the electrical wiring and adjust the travel stops in accordance with the diagram on page n° 18.

6 Try out rolling up and unrolling in order to test and optimise the position of the **SECURitech design**.

7 Mark out and definitively fasten the flanges. Drill at 10.5 for the M10 studs.

### SECURitech design in large width

For widths greater than 6m, there will be two removable upper panels fixed in the centre by 2 lateral screws.

3

4

5

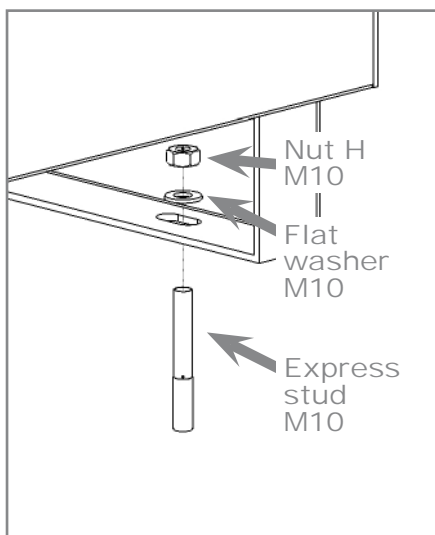
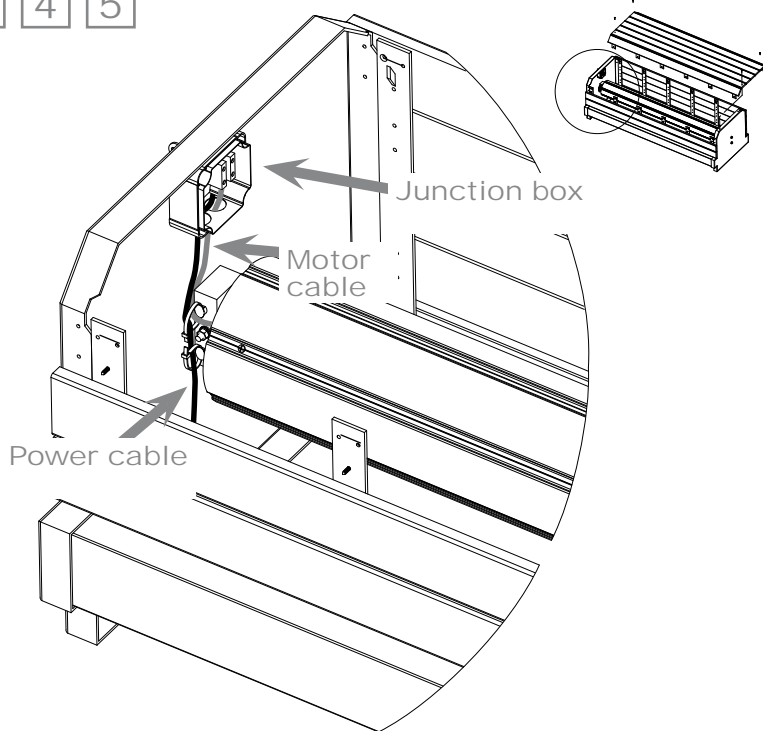

### SECURitech design in large width

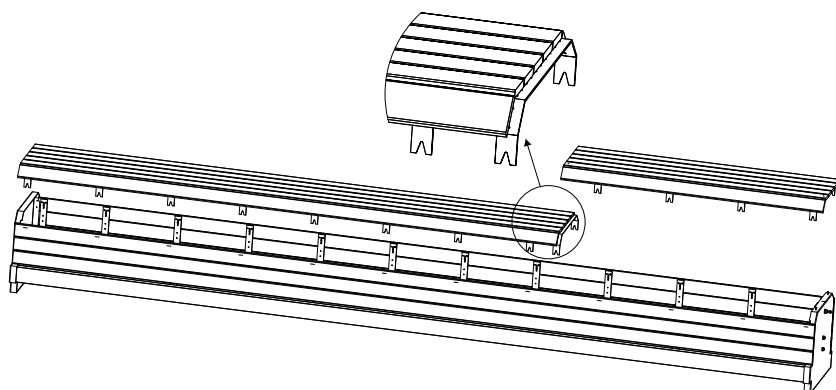

# SECURitech solar Above water slatted safety cover

- |   |                            |  |
|---|----------------------------|--|
| [1] 1 SECURitech solar roller shaft       | [7] 1 Tooth lock washer M8 | [13] 8 Flat washer M10                 |
| [2] 1 SECURitech solar motor base stand   | [8] 1 Nut H M8             | [14] 8 Express stud M10                |
| [3] 1 SECURitech solar bearing base stand | [9] 1 Motor side casing    | [15] 1 End stop adjustment screwdriver |
| [4] 1 Pin clip                            | [10] 1 Bearing side casing | [16] 1 Instructions                    |
| [5] 1 Screw M8x80 (or M6x70)              | [11] 2 Battery 12V 7Ah     |  |
| [6] 2 Flat washer M8                      | [12] 8 Nut H M10           |  |

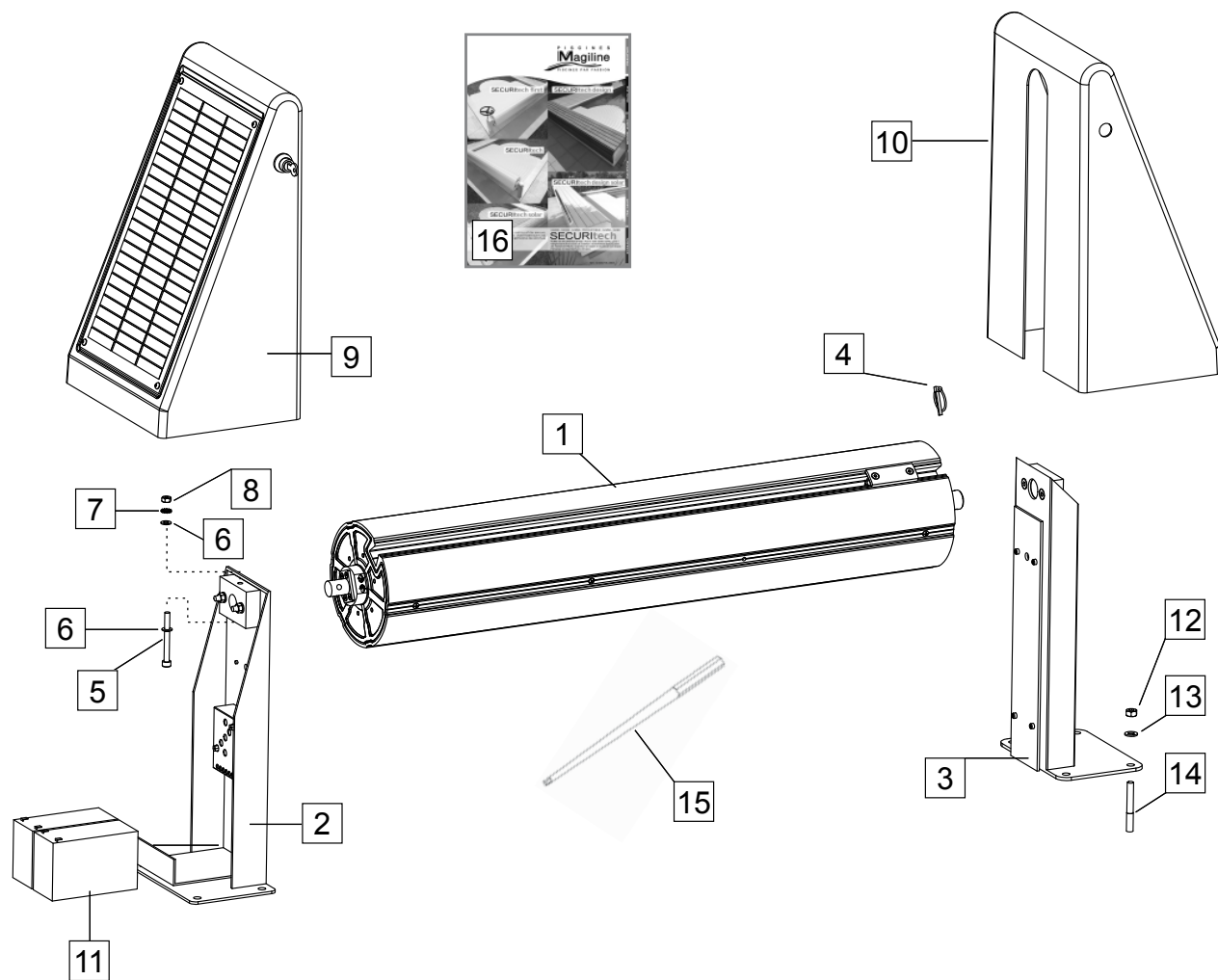

## 1 Assembly

3

1 Insert the motor drive shaft into the base stand equipped with the regulator and the battery holder.

2 Pin clip the motor drive shaft and the roller shaft bearing using the (M8x80 or M 6x70) nut and fasten the whole by tightening the nut over the washer above the roller shaft bearing.

3 Insert the drive shaft bearing in the other base stand.

4 Put the circular pin clip in place.

5 Fasten the two base stands against the roller shaft and position the roller over the pool so that the shaft is level and perpendicular to the direction of unrolling of the slatted cover.

6 Choose the side most exposed to the sun for the motor base stand.

7 Mark the position of the 8 base stand fixing points.

8 Shift the roller out of the way.

9 Drill the coping edges at 10.5 mm

10 Fill the holes with chemical sealant following the cartridge instructions.

11 Seal the threaded rods leaving 15 mm of rod above the base stand plate.

12 Leave the sealant to dry for the time indicated on the cartridge (depending on the surrounding temperature).

13 Put the washers in place.

14 Tighten the nuts and put the nut covers in place.

15 Four additional thin nuts per base stand are supplied in order to allow horizontal wedging underneath the plates. (Opposite).

16 Place the batteries on their holder.

17 Connect the electrical wiring according to the diagram on page n°19.

18 Thread the casing equipped with the panel onto the motor side base stand and screw the casing clamp piece.

19 Carry out the same procedure on the bearing side.

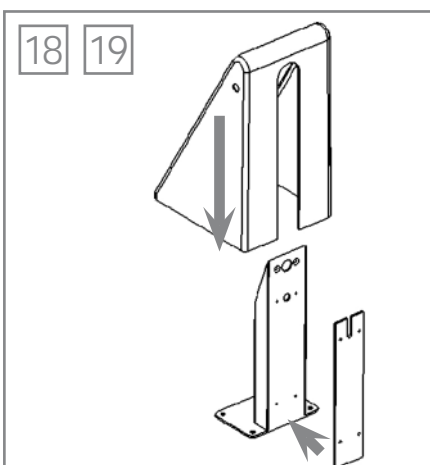
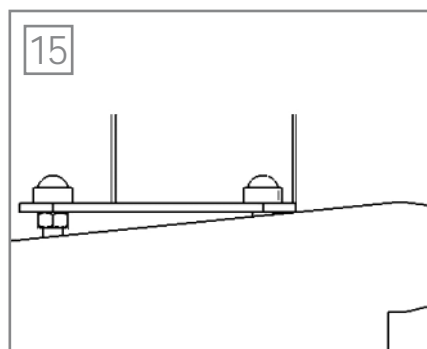
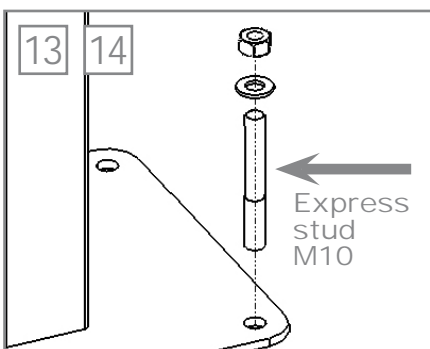
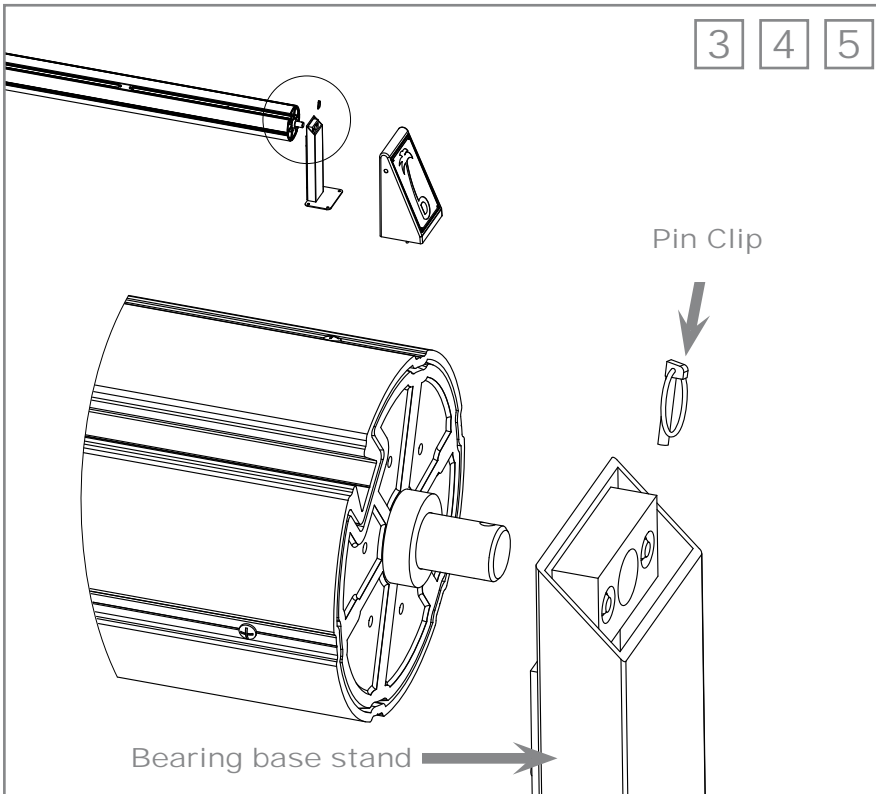
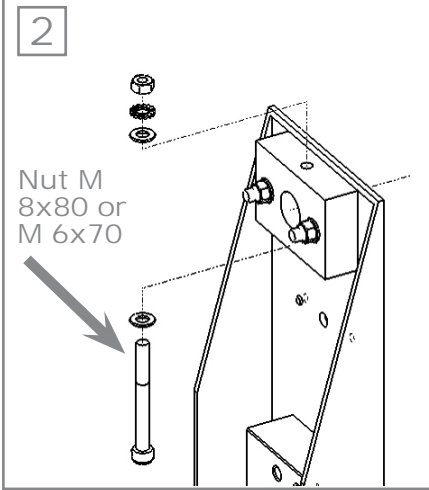

# SECURitech design solar Above water slatted safety cover

- |  |                                   |   |
|--|-----------------------------------|---|
| <b>1</b> 1 SECURitech design solar mechanism | <b>3</b> 1 Removable top          | <b>11</b> 1 Wing screw M6x20                |
| <b>2</b> 1 SECURitech design solar case      | <b>4</b> 1 Screw M8x80 (or M6x70) | <b>12</b> 4 TFPZ M6x20                      |
| <b>2a</b> 1 Case                             | <b>5</b> 2 Flat washer M8         | <b>13</b> 1 Rapid panel connector           |
| <b>2b</b> 2 Battery 12V 7Ah                  | <b>6</b> 1 Tooth lock washer M8   | <b>14</b> 1 End stop adjustment screwdriver |
| <b>2c</b> 1 Regulator 5A                     | <b>7</b> 1 Nut H M8               | <b>15</b> 1 Instructions                    |
| <b>2d</b> 1 Key operated switch              | <b>8</b> 4 Nut H M10              |   |
| <b>2e</b> 1 Reset button (REARM)             | <b>9</b> 4 Flat washer M10        |   |
| <b>2f</b> 2 Plastic thick nut H M3x30        | <b>10</b> 4 Express stud M10      |   |

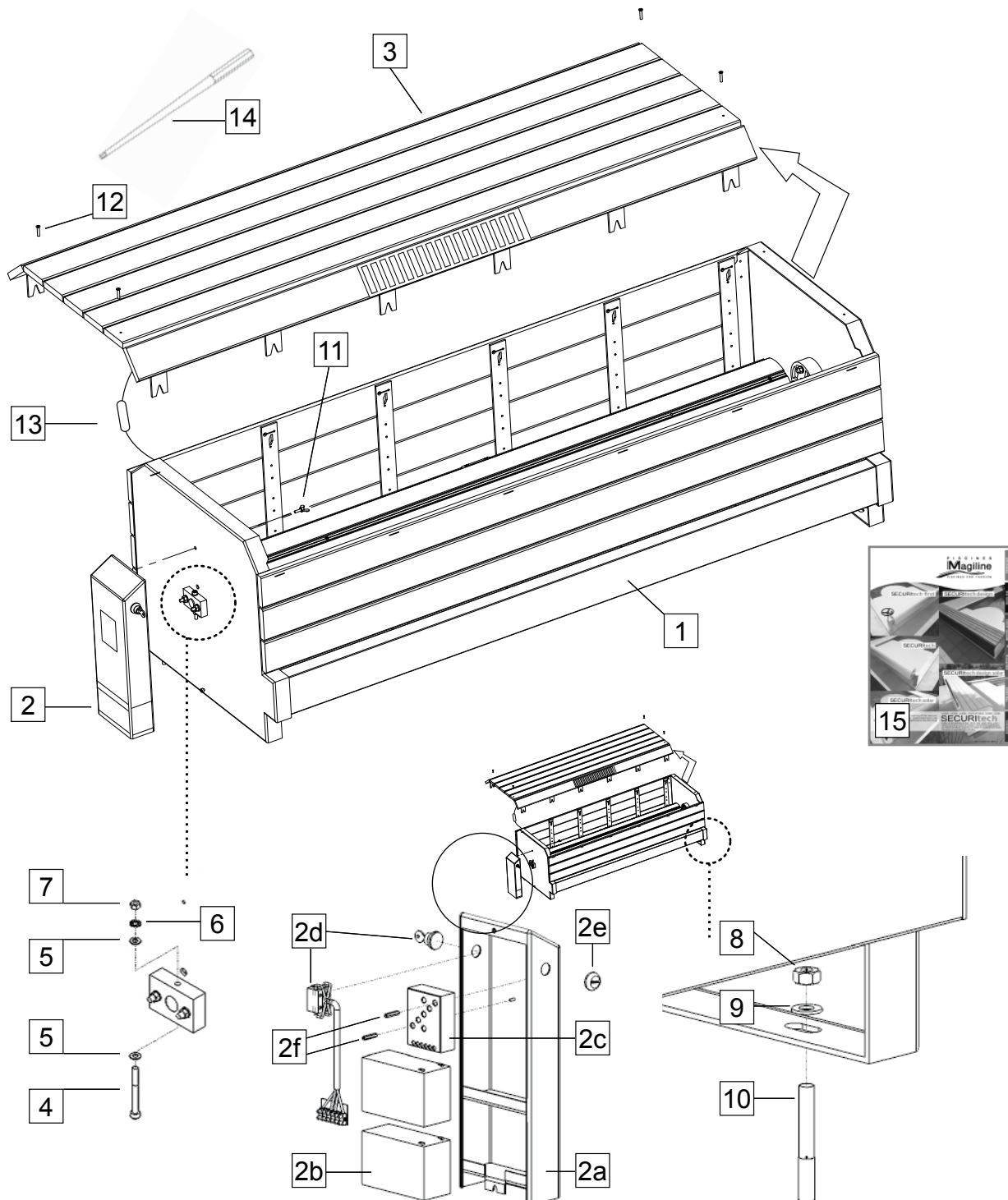



## 1 Assembly

3

1 Take off the removable top by undoing the screws (TFPZ M 6x20) and slightly lifting the whole of the panel (2 people necessary) to gain direct access to the rapid connection to be disconnected and to the motorised roller shaft. For widths greater than 6m the top is in two parts to be removed separately.

2 Position the bench directly on the levelling course (low beam on the side of the bathing pool).

3 Unscrew the wing screw in order to make it possible to slightly lift the case in order to remove it.

4 Connect the electrical wiring and adjust the travel stops in accordance with the diagram on page n° 19.

5 Try out rolling up and unrolling in order to test and optimise the position of the Bench.

6 Mark out and definitively fasten the flanges. Drill at 10.5 for the M10 studs.

**SECURItch design solar in large width**

For widths greater than 6m, there will be two removable upper panels fastened in the centre by 2 lateral screws.

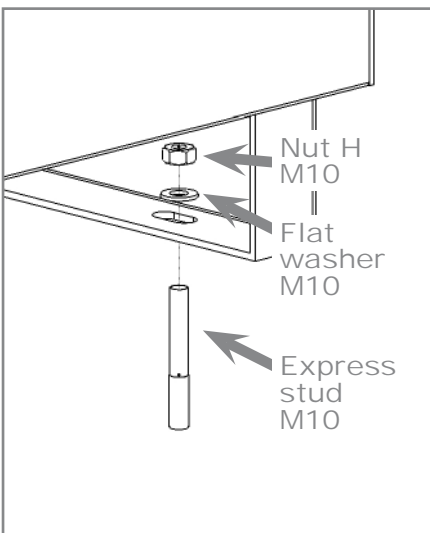
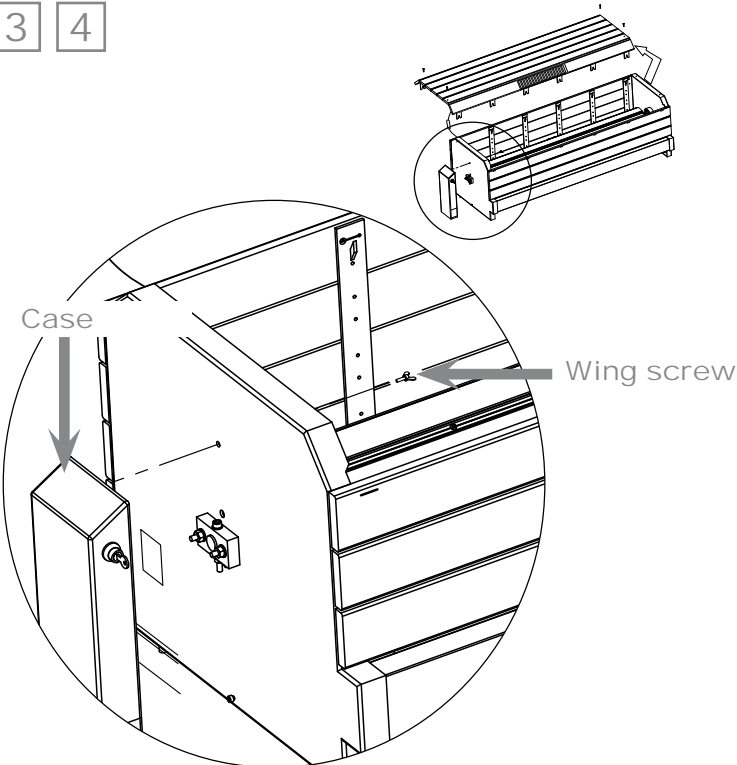
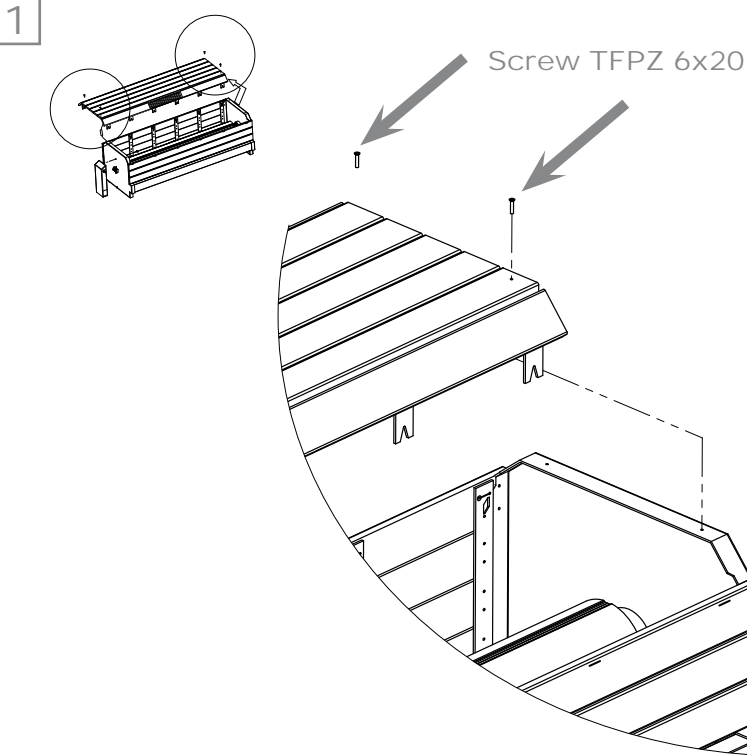
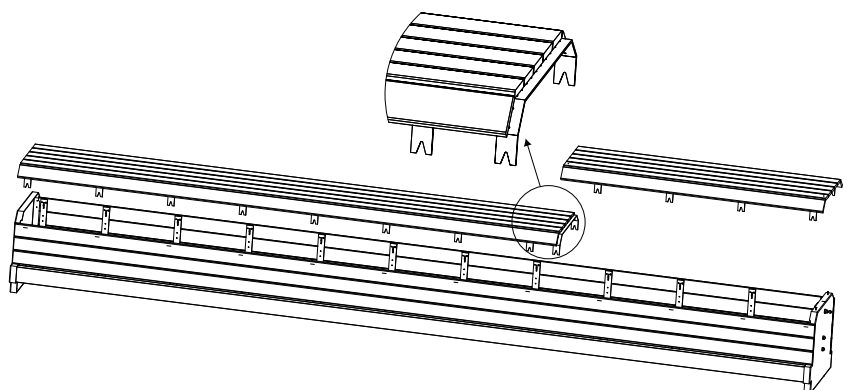
**SECURItch design in large width**

**Magiline**  
PISCINES PAR PASSION

**Range SECURITEch**  
Piscines MAGILINE - 7 rue du Général Sarrail - 10 000 TROYES FRANCE

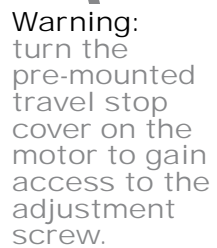

## Adjustment of motor travel stops

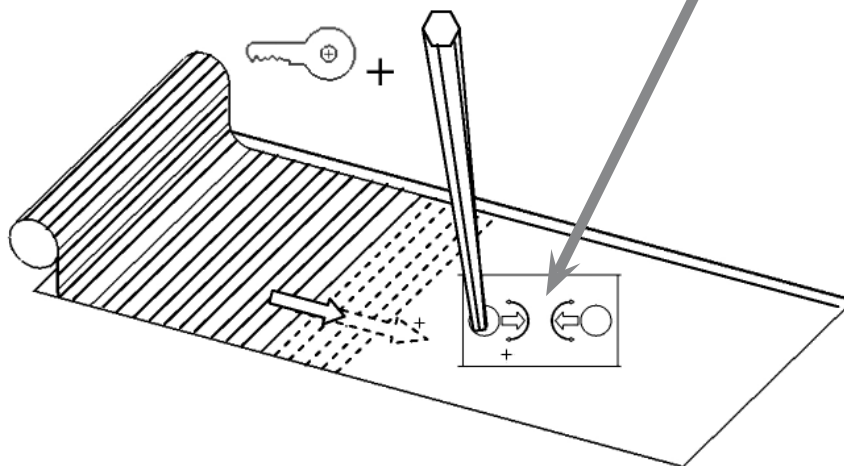

# SECURItch solar and SECURItch design solar electrical connections

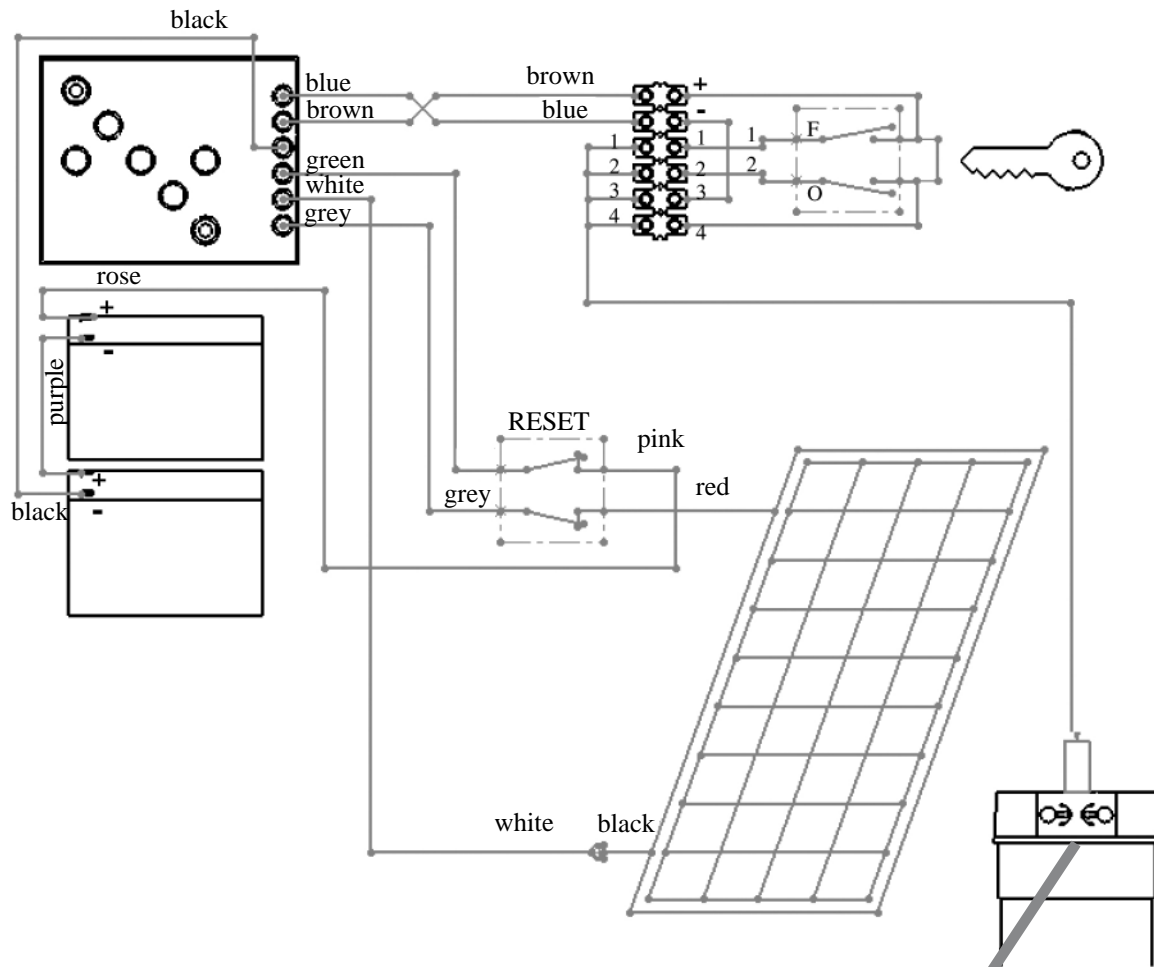

Adjustment of motor travel stops

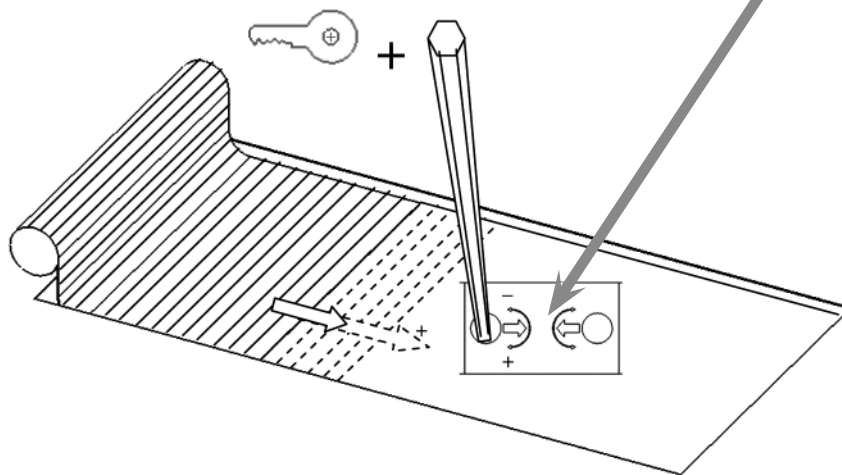

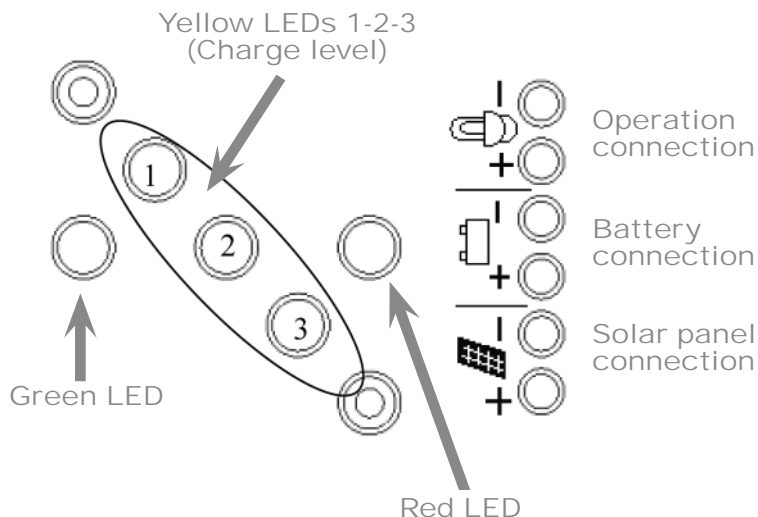

## Resolution of faults

Order of tests	
<b>Resetting</b>	By pressing the “ <b>REARM</b> ” button the user puts the system into operation for closing the pool
<b>Connections</b>	Unfasten the connections one by one and carefully refasten them on the conducting part of the wire
<b>Regulator</b>	Charging constantly except if: Lack of light Damaged panel Full batteries Incorrect connections  <b>Red LED lit up and REARM inefficient:</b> Batteries out of service, leave to charge
<b>Switch</b>	Simulate an action of the key operated switch by making a bridge between 4 and 1 then between 4 and 2 (never power 1 and 2 at the same time)
<b>Moto reducer</b>	Directly power the motor with the batteries: 4 on the + and 3 on the – then, in turn, 1 or 2 on the + to control the rotation

### SOLAR MODELS

- The motor power supply is ensured by two electronically regulated batteries powered by a high performance photovoltaic panel, which allow 10 autonomous cycles (in full charge).
- The solar panel is necessarily placed on the exterior and correctly positioned, avoid due north! A minimum of 5 hours direct exposure allows normal operation everywhere in France all year round.
- Opening the **SECURItch design solar** necessitates the disconnection of the panel wires (key side)
- An alarm signal indicates low battery charge levels while ensuring an entire final opening/closing cycle.

#### Regulation functioning:

The regulator emits alarm signals to inform the user of changes in the state of the batteries:

- 1 ring: the charge level has fallen below 75%,
- 3 rings: the charge level has fallen below 25%,
- 5 rings, the charge level has fallen below 10%,
- 25 rings, the system secures itself (see resolution of faults).

**The regulator emits light signals to inform the user of changes in the state of the batteries** (see table opposite)

#### Yellow LEDs

##### - Charge levels

- Yellow LED 1 LIGHTS UP  $\geq 75\%$
- Yellow LED 2 LIGHTS UP  $\geq 25\%$
- Yellow LED 3 LIGHTS UP  $\geq 10\%$
- Yellow LED 3 FLASHES  $\leq 10\%$

#### Green LED

- lit up constantly: CHARGING

#### Red LED

- flashing: SHORT CIRCUIT
- lit up: SAFETY



- For proper functioning, a few centimetres of play is necessary to compensate for the expansion of the slats in full sunlight and to avoid a high level of friction between the end caps and the liner. This play is adjusted in compliance with the norm, which authorises lateral play of 7 cm maximum. We advise you to ensure that there is effectively 2.5 cm of play between the slats and the pool walls.
- The slats are assembled by clipping together with the double hook and not by threading.
- The blocking waterproof end caps are provided with standard removable wings of 20 mm. Wings of 10, 15, 25 and 30 mm are available on order.
- The opaque slats are suitable for all slatted covers.
- Translucent solar slats are forbidden for the **SECURitech first** and **SECURitech** slatted covers. They provide free heating of 3 to 5°C of the water temperature.
- **Warning, lateral movement of the cover may be caused by wind.**

### PRECAUTIONS TO TAKE WITH THE SLATS

- Before being installed, they should always be protected from the sun and the temperature.
- The translucent solar slats must on no account be stored in the sun even for a few minutes. They should be stored in our container, which includes a protective film, and in a place of moderate temperature.
- The translucent solar slats should always be in contact with the pool water whose temperature at any given spot should not be in excess of 28°C. Be very prudent with heat pumps.
- The slats should not be exposed to a temperature difference of more than 15°C between the exterior air and the upper water (highly heated swimming pool in cold environment: mountain etc.)
- Monitor the temperature under shelter to avoid overheating of the slats and irreversible distortion.
- You should imperatively avoid friction of the slats and their end caps against the ground when unloading the crate.
- The filtration should never take in air which, once discharged, goes back up to the surface to form a layer of air underneath the slatted cover. In this case, the absence of contact of the slats with the pool water can cause distortion of parts of the slats in the form of semi-spheres or bubbles.

### CLIPPING TOGETHER OF THE SLATTED COVER

- To clip one slat into another, first place (fig. 1) the lower hook of the right-hand slat's male part into the left-hand slat's female groove.
- Repeat the swaying movement (fig. 2) until the complete clipping together of the slat.
- Fix the 1st panel of slats, equipped with rolling straps, using the strap flat clamp pieces. Spread out the slatted cover side play in an equal manner.
- The end caps are equipped with 20mm wings. To adjust the width of the slatted cover to that of the pool, you can take them off and, if necessary, replace them with 10, 15, 25 or 30 mm wings ordered from us.
- Any cutting of end caps nullifies the guarantee of watertightness and of rigidity of the slat and the slatted cover apron.
- To unclip a slat, reverse the procedure (of fig. 1) by pressing on the lower part of the female groove (left-hand slat) to free the male part's upper hook (right-hand slat).

### CLIPPING TOGETHER OF THE STAIRCASE

Take off the slat's male part (in the dotted line) to fix the staircase and in order not to damage the liner.

### Clipping together of the slatted cover apron

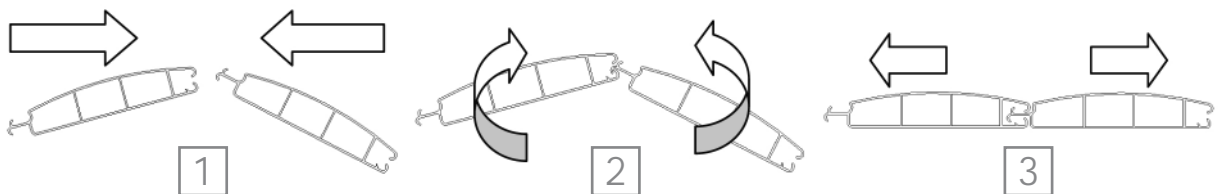

Staircase Roller shaft

### Clipping together of the staircase

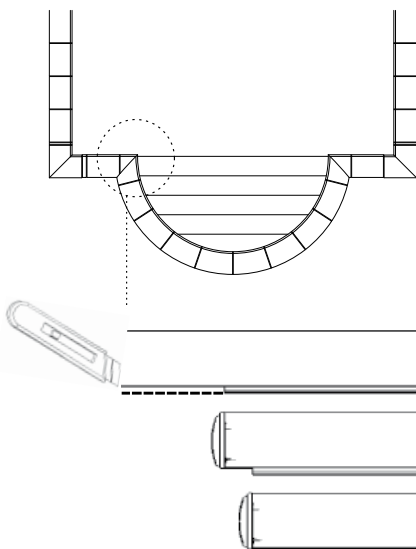

### Fixing of the slatted cover apron onto the roller shaft

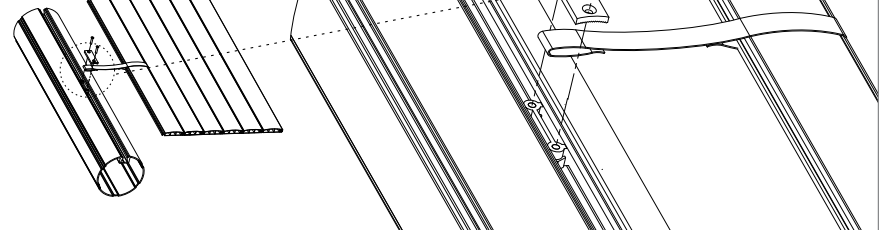

### Putting in place of the first slat's guide rail

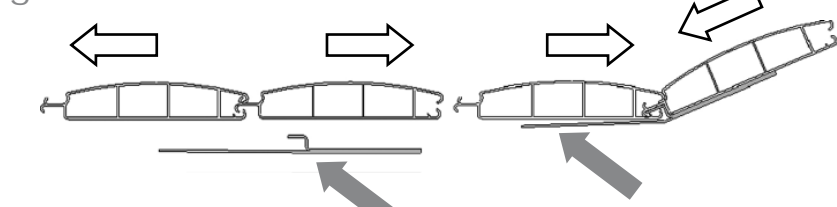

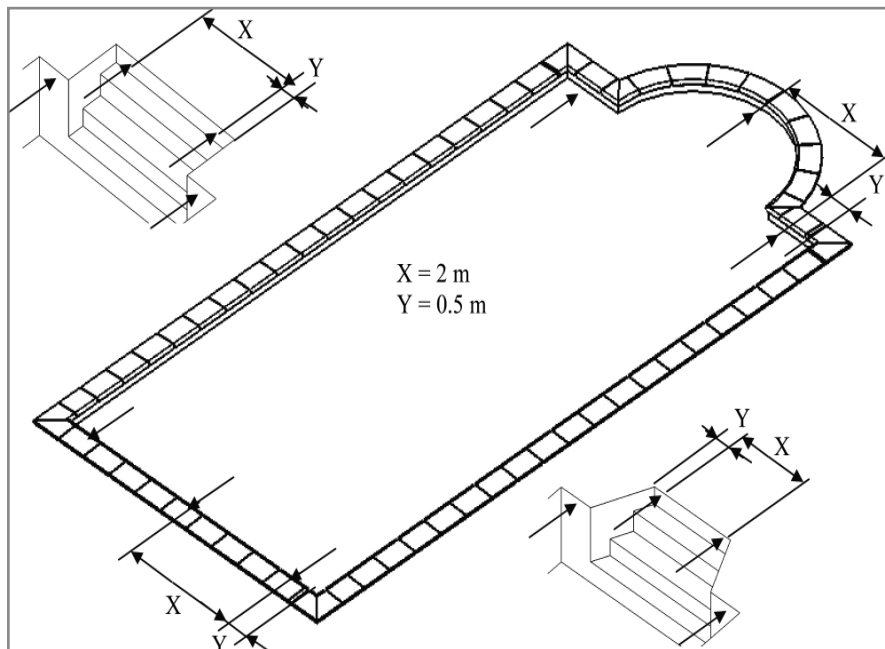

## 2 Safety mechanism

**POSITIONING AND FIXING**  
Only the **SECURitech first**, **SECURitech** and **SECURitech solar** models necessitate fixing of the slatted cover apron equally on the side of the roller.

- |  |                     |                                  |
|--|---------------------|----------------------------------|
| 1 Bracket support for anti-lifting mechanism     | 8 Joint washer Ø5   | 15 Levelling course buckle plate |
| 2 Centre support 50mm                            | 9 Nylon peg Ø5      | 16 Anti-lifting buckle           |
| 3 Screw TFHC M5x20                               | 10 Screw TFHC M8x35 | 17 Flat washer M5                |
| 4 Cover nut M5                                   | 11 Brass peg M8     | 18 Screw TFHC M6x30              |
| 5 Strap for kit to prevent lifting onto the deck | 12 Screw TFHC M5x16 | 19 Brass peg M6                  |
| 6 Retractable piton on deck                      | 13 Screw TFHC M5x12 |                                  |
| 7 Lag screw Ø5x40                                | 14 Buckle support   |                                  |

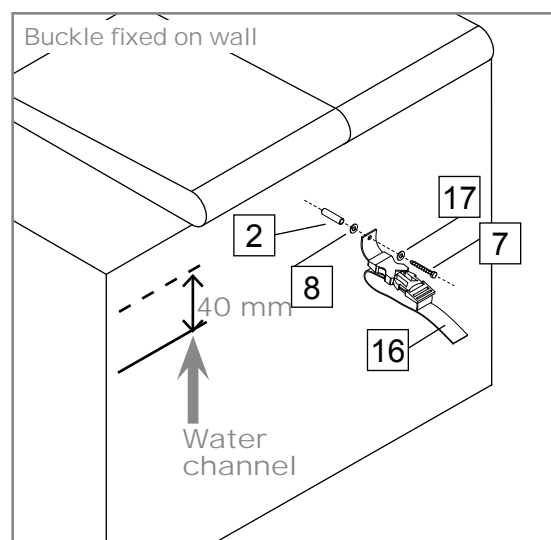
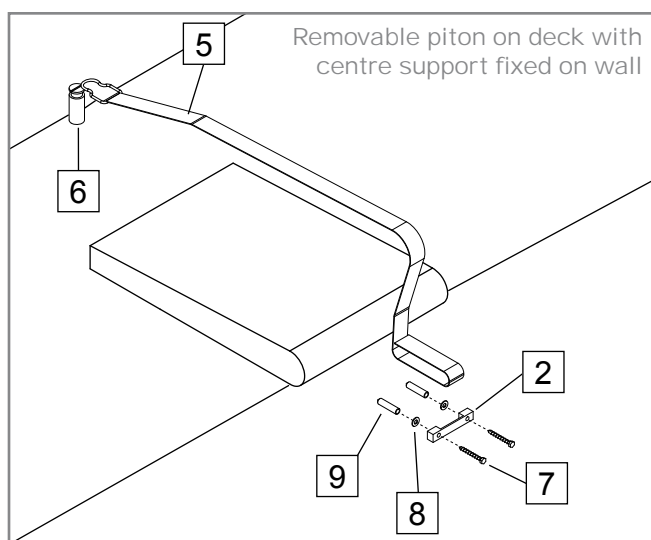
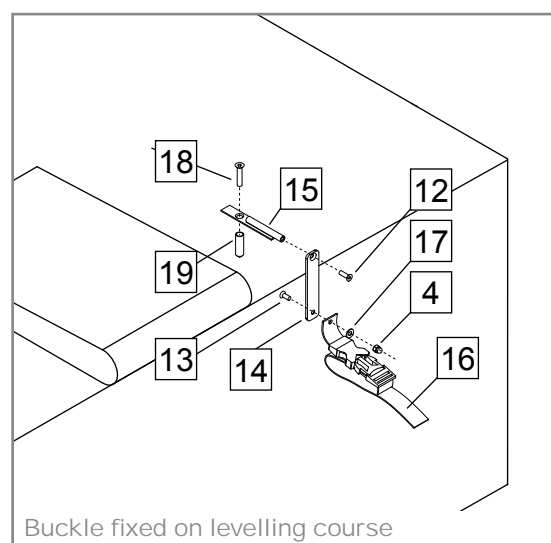
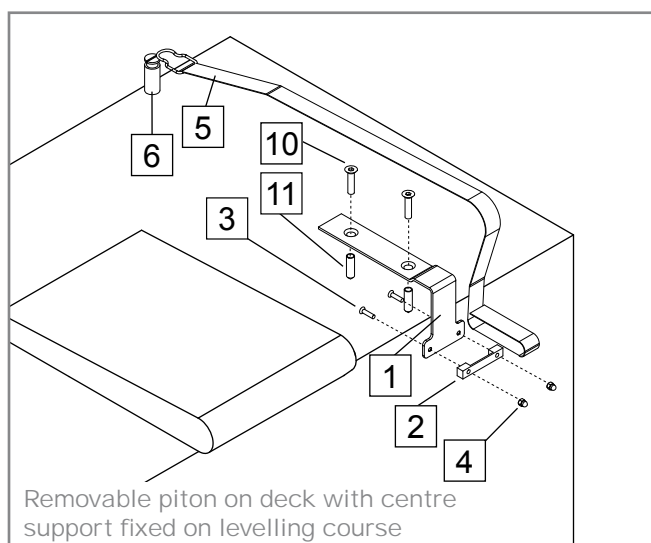

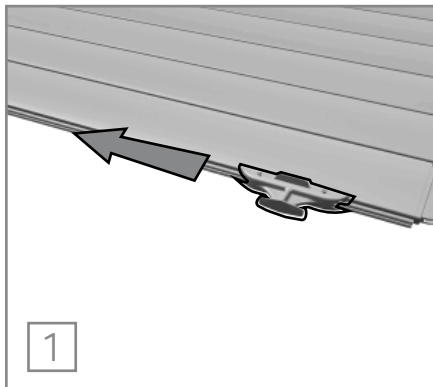

1

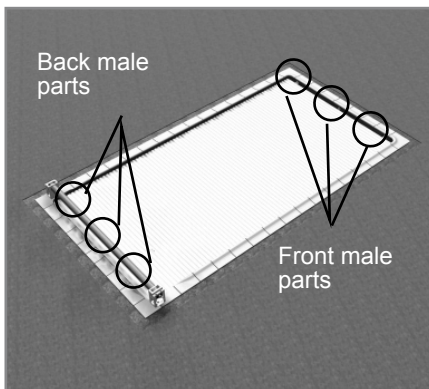

Back male parts

Front male parts

### 3 Installation of the safety components

#### SECURItch Model

- 1 Slide the male safety attachments in front of the female parts
- 2 Lock the slatted cover and close the security pins.
- 3 Screw the front male parts to the slatted cover (no screws for the back male parts).

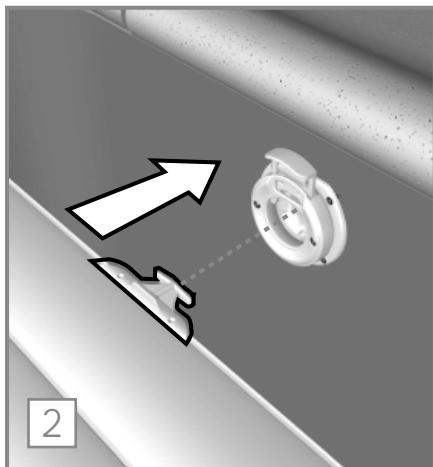

2

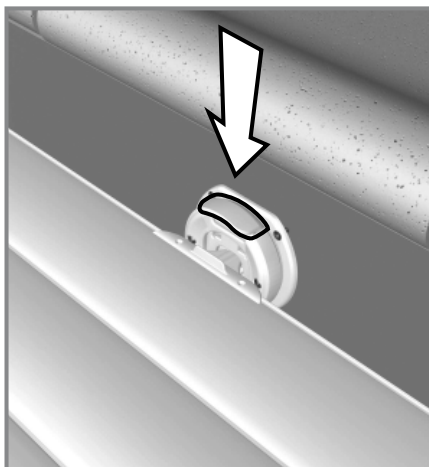

Side view of the sliding of a back male part into a slat.

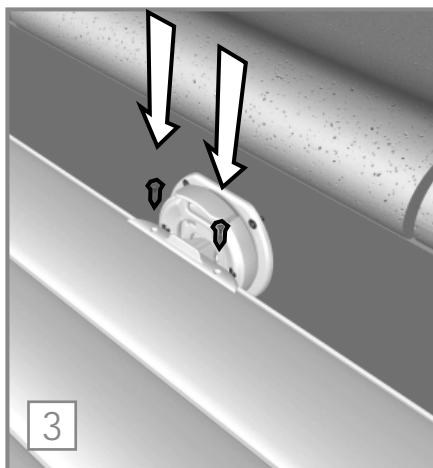

3

4

Finishes

ENGLISH